

480

METCALF, D. F., et. ux., Ora E.

QUITCLAIM DEED

(249)

YSLA LATERAL

0023-0079-0007-00

13-(7) Texas

482

THE STATE OF TEXAS, }
COUNTY OF EL PASO, }

Know all Men by these Presents:

THAT We, De F Metcalf and Ora E Metcalf, husband and wife,

of the County of El Paso, State of Texas, for and in consideration of the sum of One and 0/100 (\$1.00) DOLLARS,

to ~~us~~ in hand paid by The United States of America, pursuant to the act of Congress of June 17, 1902 (32 Stat. 388),

~~of the County of~~ ~~and~~ ~~of~~ ~~the~~ ~~County~~ ~~of~~ ~~the~~ ~~State~~ ~~of~~ ~~Texas~~, the receipt whereof is hereby acknowledged, do by these presents Bargain, Sell, Release and Forever Quit-Claim unto the said

The United States of America and its

~~heirs~~ assigns all our right, title and interest in and unto that tract or parcel of land lying in the County of El Paso, and State of Texas, described as follows, to-wit:

A tract of land in the southeast quarter of the northeast quarter of section seven (7), township thirty-two (32) south, range seven (7) east, United States Reclamation Service survey, being also in the Socorro Grant, and more particularly bounded and described as follows: Beginning at a point on the center line for the Vela lateral and on the property line between land of the Grantor herein and William Moon, from which point the northeast corner of said section seven (7) lies north 1334.8 feet and east 305.6 feet; thence with said property line south 89°53' east 31.2 feet; thence south 15°51' east 317.1 feet to the property line between land of the Grantor herein and George Huffman; thence with said property line south 77°40' west 59.6 feet to the northwest corner of said Huffman tract; thence with the property line between land of the Grantor and said George Huffman south 20°09' east 401.7 feet to a point which is the southeast corner of land owned by the Grantor herein and the northeast corner of land claimed by H. A. Brockmoller, from which point the northeast corner of said section seven (7) lies north 2,032.6 feet and east 107.7 feet; thence with said property line west 31.8 feet; thence north 15°51' west 722.5 feet to the property line between land of the Grantor herein and said William Moon; thence with said property line south 89°53' east 31.2 feet to the point of beginning; said tract of land herein described containing five hundred and eighty-eight thousandths (0.588) acre, more or less;

TO HAVE AND TO HOLD all our right, title, interest, estate and claim in and to the said premises, together with all and singular, the rights, privileges and appurtenances to the same in any manner belonging, unto the said The United States of America and its

~~heirs~~ assigns forever.

WITNESS our hand S this the 24th day of June, A. D. 1918

Correct as to Engineering Data

QUIT-CLAIM DEED

SINGLE AND WIFE'S SEPARATE
ACKNOWLEDGMENTS

TO

Filed for record, this

day of 1918, at

o'clock and minutes M.

Clerk.

By Deputy.

Ellis—El Paso

THE STATE OF TEXAS, }

COUNTY OF EL PASO, }

Before me, Geo W Hoadley Notary Public

in and for

El Paso County, Texas, on this day personally appeared De F Metcalf

known to me to be the person whose name is subscribed to the foregoing instrument, and acknowledged to me that he executed the same for the purposes and consideration therein expressed.

Given under my hand and seal of office, this 24th day of June, A. D. 1918

(SEAL)

GEO W HOADLEY

My com exp 6/1-19

Notary Public In and For El Paso Co Tex

THE STATE OF TEXAS, }

COUNTY OF EL PASO, }

Before me, Geo W Hoadley Notary Public

in and for

El Paso County, Texas on this day personally appeared Ora E Metcalf

wife of

De F Metcalf

known to me to be the person whose name is subscribed to the foregoing instrument, and having been examined by me privily and apart from her husband, and having the same by me fully explained to her, she, the said Ora E Metcalf acknowledged such instrument to be her act and deed, and declared that she had willingly signed the same for the purposes and consideration therein expressed, and that she did not wish to retract it.

Given under my hand and seal of office, this 24th day of June, A. D. 1918

(SEAL)

My com exp 6/1-19

GEO W HOADLEY

Notary Public In and For El Paso Co Tex

THE STATE OF TEXAS, }

COUNTY OF EL PASO, }

I W. D. Greet Clerk of the County

Court of said County, do hereby certify that the above instrument of writing, dated on the 24 day of June, A. D. 1918 with its certificate of authentication, was filed for record in my

Mrs. Wm. Moon

N. 1334.8' and E. 305.6' to
N.E. Cor. Sec. 7, T. 32S, R. 7E.

Sta. 57+36.5 31.2 31.2 5.89°53'E.

YSLA LATERAL

D. F. Metcalf

S. 15°51'E. 317.1'

D. F. Metcalf

59.6' 5.77°40'W.

N. 15°51'W. 722.5'
S. 20°09'E. 401.7'

Geo. Huffman

W. 31.8' N. 2032.6' & E. 107.7' to N.E. Cor.
H. A. Throckmoller Sec. 7, T. 32S, R. 7E.

Scale: 1" = 100'

Department of the Interior
United States Reclamation Service
RIO GRANDE PROJ. N.M.-TEX.
YSLA LATERAL SCHED. 1.
RIGHT OF WAY

Drawn A.O.D. Recommended
Checked Approved

1294 L64 El Paso, Texas 6/4/18

T. 32S. R. 7E.

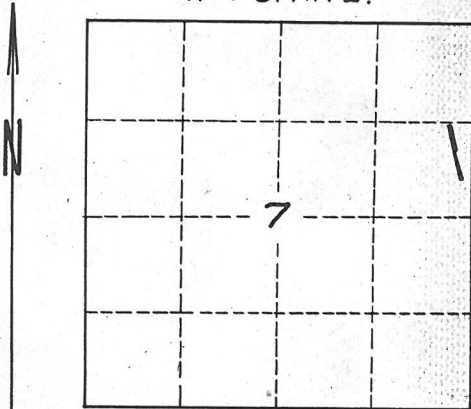

Location Plat

RIGHT OF WAY
Through Property
D. F. METCALF
.588 Acre.

In S.E. 1/4 of N.E. 1/4 Sec. 7, T. 32S, R. 7E.
U.S.R.S. Survey and Socorro Grant,
El Paso County, Tex.

Q.C.D. 6/24/18
Rec 6/27/18 BK 324 Pg 55

7

DEPARTMENT OF THE INTERIOR
UNITED STATES RECLAMATION SERVICE

El Paso, Texas, _____, 19

Project Manager to the Director and Chief Engineer ~~(through Chief of Construction)~~

Subject: Forwarding ~~contracts for approval~~ **donation deed for acceptance.**

The contract described below is forwarded herewith.

~~Agreement~~ **Deed** dated **June 24, 1918** **El Grande** Project.

Executed by **De F Hetschik and Ora E Hetschik, husband and wife,**

~~with~~ **The United States of America.**

Estimated amount involved, \$ _____ (See Reverse, Par. 3.)

Purpose of agreement: **Donation of right of way for Isla lateral system.** Authority **5-3-5.**

Inclosures listed on reverse. (See Par. 5.)

Advise Chief of Construction, Denver, Colo., and Project Manager at **El Paso, Texas,** and **District Counsel**

at **El Paso, Texas** of the approval of the above.

Inclo. **Original deed.**
Certificates as to title.
1 blueprint.

L. H. LARSON

(Signature.)

Denver, Colo., _____, 19

It is recommended that the above-described contract be approved

Inclosures:

_____ copies of contract.
_____ copies of form letters of transmittal.

Chief of Construction.

Washington, D. C., **SEP 9 - 1918**

Contract (and bond, if any), was ~~approved by~~ **accepted by:**

on **Merris Bien, Acting Director.**

SEP 3 '18 86237

(Over.)

DEPARTMENT OF THE INTERIOR
BUREAU OF RECLAMATION
INSTRUCTIONS.

1. This form is devised to render unnecessary the writing in the Washington and Denver offices and in the field of various routine letters in reference to contracts.

2. The project or other office where the contract originates will transmit **two copies** of this form **in excess** of the number of offices which are to be advised of approval. For example, in the usual case where the Project Manager and Chief of Construction are to be advised, four copies should be sent to the Denver Office.

3. The information requested in General Order 124 of March 23, 1916, and Amendment 1 thereof dated August 11, 1916, should be written in the space below, and any other special matter or information relative to the contract, should also be written in the space below, but if too long to write on this form, it should be set out in a statement or certificate accompanying the contract.

4. When reference is made to previous correspondence, the dates thereof should be given.

5. The office from which this contract originates, should list all inclosures below.

Inclosures:

-copies of contract.
-copies of form letters of transmittal.

6-4533

(over)

CERTIFICATE.

I HEREBY CERTIFY, With reference to the following described land:

A tract of land in the SE $\frac{1}{4}$ of NE $\frac{1}{4}$ sec. 7, T. 32 S., R. 7 E., United States Reclamation Service survey, El Paso County, Texas, more particularly described in quitclaim deed dated June 24, 1918, running from De F. Metcalf and wife to the United States of America:

That the tax records of said county indicate De F. Metcalf, the reputed owner, to be the actual owner; that there are no unsatisfied mortgages or other liens existing against said land; and that the land is not occupied adversely to the reputed owner.

C. F. HARVEY

Clerk.

El Paso, Texas,

July 9, 1918.

CH

El Paso, Texas, June 24, 1918.

County Clerk for El Paso County,

El Paso, Texas.

Dear Sir:

Transmitted herewith for official record are quit-claim deeds dated June 24, from Edith Giddings and May Anderson to the United States and from De F Metcalf and wife to the United States.

Very truly yours,

P W DENT CEB

District Counsel.

2 incls.