

PETITION

VALLEY GATE AREA LATERAL & DRAIN

0023-0072-0018-00

5-(18), 6-(38)

EL PASO COUNTY WATER IMPROVEMENT DISTRICT NO. 1

El Paso County, Texas

A PETITION

FOR

THE RECLAMATION OF THE VALLEY GATE AREA

by

THE CONSTRUCTION OF
DRAINS, LATERALS AND LEVIERS by

THE UNITED STATES RECLAMATION SERVICE

From property owners in the District, assuming
the extra cost thereof and granting the neces-
sary right of way therefor, subject to clauses
and conditions stated in the petition.

PETITION

WHEREAS, by reason of the topography and other physical conditions, the reclamation of the Valley Gate area, comprising about 1,000 acres of land situate within the boundaries of the El Paso County Water Improvement District No. 1, as shown more in detail on print hereto attached and made a part hereof, is attended with unusual difficulties and will involve a cost in excess of that with which other areas of the said water improvement district may be reclaimed; such reclamation requiring the construction of levees to protect said area from overflow, erosion, avulsion, or other damages arising from the location of the Rio Grande with reference to said area, in addition to the other facilities ordinarily required for reclamation; and,

WHEREAS, the owners of the land within said area desire the construction and operation of the necessary works for the reclamation of said lands despite the difficulties to be encountered and the additional risk involved.

NOW, THEREFORE, we the undersigned owners of land situate in said area, hereby petition the United States Reclamation Service to construct, operate and maintain such levees, drainage ditches, irrigation canals, and other works as may be considered necessary for the reclamation and protection of said area, and in consideration of the benefits to be derived from such works, we, and each of us, hereby agree that the cost of constructing, operating and maintaining said works over and above the cost of reclaiming other lands generally within said water improvement district shall be paid by the landowners of said Valley Gate area, in accordance with the special benefit which said landowners may receive by reason of the works so to be constructed, operated and maintained. Such excess cost to be borne by the landowners of said Valley Gate area shall be fixed by the proper taxing authorities or other officers whose duty it is or may be to determine such charges in accordance with contracts between said El Paso County Water Improvement District No. 1 and the United States made and to be made pursuant to the various provisions of law applicable. Such charges shall be paid in the same manner that other charges are collected on account of construction and operation and maintenance.

We, the undersigned for and in consideration of the benefits to be derived from the construction and operation of the works hereinbefore mentioned upon, across or in the vicinity of our lands, hereby further agree, upon request of the proper officers of the United States Reclamation Service, to convey to the United States without charge the necessary right of way for any and all drainage ditches, irrigation canals, levees and other works which may be required and be constructed. Such right-of-way shall be conveyed by quit-claim deed or other instrument or instruments in writing satisfactory to the United States, the location and extent of such right-of-way to be determined by the proper officers of the United States Reclamation Service.

WITNESS our hands and seals this
A.D., 1921.

11th day of April

Jennings & Martine

By Jennings

Attor. of Jenn. Martine

By Jennings agent

V. D. Bridges

W. D. Bridges

James D. Hume

John M. Hyatt

Isabel W. Hoer

Mary Hahn

Danny E. Smith

E. G. Granch

Catarina Padregon

J. D. Fabry

Ed. Fabry

Geo. W. Orr

W. C. Olson

Alice J. Davis

W. D. Bridges

Donna Maria Salas

Mrs. D. Vaquer

L. M. Ramsey

L. D. Chapman

Jos. M. Decker

Tom Lea

Christina

Laura Davis

C. M. Mason

Steamer Dawn

Madrid By Amundson

G. J. Vance

P. H. Savage

J. L. Savage

By M. L. Caldwell ^{Roadside Found} _{Miz}

Blank lined area for notes or additional entries.

LIST OF PROPERTY OWNERS OWNING LAND IN THE VALLEY GATE DISTRICT

(Property owners do not sign here; sign on space provided)
(under petition)

-0-

Ownership (as shown on map)	PRESENT OWNER (To be checked off as signed (up by Right of Way Committee)	Date Signed
1. H.B.Stevens ✓		
2. Silberberg & Martinez ✓		
? 3. W.H.Elliott ?		
4. Tobin & Wingo ✓		
? 5. G.W. Sharp Est. ?		
6. J.F.Knox a w. Carl		
? 7. Mrs.H.R. Safford		
8. P.Crowley		
9. F.B.White. Geo. Orr ✓		
10. J.M.Oechaner ✓		
11. Wyatt & Wingo ✓		
12. C.B.Holdsworth 1701 N 1 +		
13. Lathan		
264 14. C.W. Croon ✓		
15. V.G. & A.R. Burges ✓		
16. F.M.Wingo ✓		
17. C.P. & W.L.Brown o In lease		
18. S.G. Gonzales ✓		
19. Mrs.W.Ware ✓		
20. A.W.Duff		
? 21. H.E.Carter		
22. Donaciano Salas ✓		
23. John R.Blair Sur Carl for present owner		
24. B.Vasquez Est. ✓		

25. C. Pedregon ✓
26. G.C. Hosnes ✓
27. E.G. Kasnek ✓
28. Mrs Alice Davis ✓
29. Mary Hahn ✓
30. Reynaud & Orndorf ✓ *J.P. Rea County Realty Co*
31. H.J. Sherwood
32. L.B. Chapman ✓
33. G.A. Runsey ✓
34. C.N. Bassett ✓
35. L. Luna - *Salvador Estrada*
36. T.A. Falvey ✓
37. H. Madrid ✓
38. John H. Nusbaum, *J. K. Savage 10 a* ✓
39. W.F. Payne ✓
40. T.J. Nance *
41. Chas. T. Nagle (County Acordo?)
42. H.L. Cadwallader ✓
43. G. Pence ✓
44. James Cooper *absent*
45. Milton Rivera ✓
46. Tom Hill ✓
47. C. R. Vowell ?
48. Clarence Campbell, 7327 ✓ (*Patterson*)

*Mr
D. Robinson
living place,*

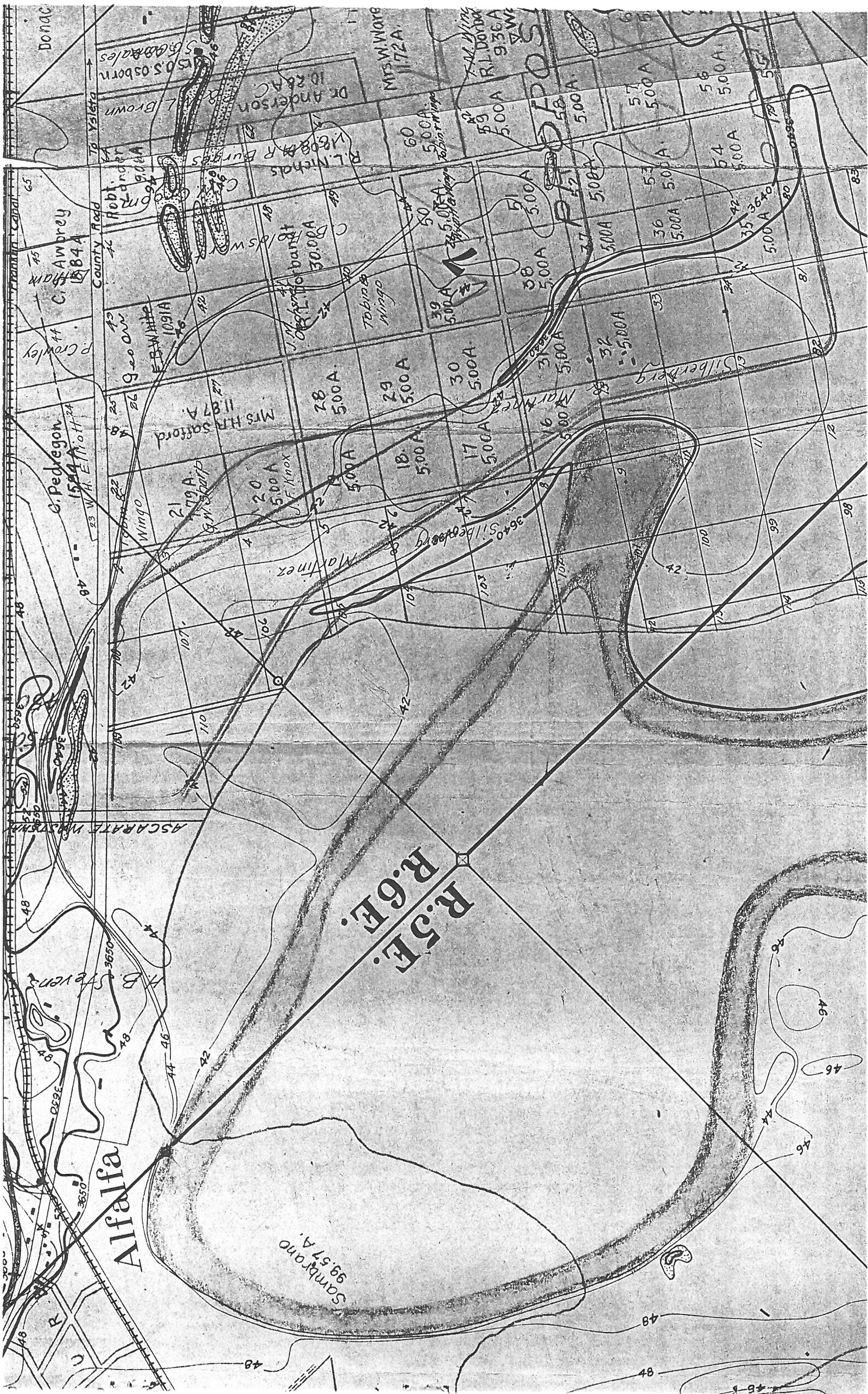

R:5E.
R:6E.

Alfalfa

Sombard
99.57 A.

PROSPERS

DONAC

Pratt Canal

County Road
To Yuleta

ASCARATE WESTERN

H.B. Stevens

R. C.

U

48

48

48

48

48

48

48

48

48

48

48

48

48

48

48

48

48

48

48

48

48

48

48

48

48

48

48

48

48

48

48

48

48

48

48

48

48

48

48

48

48

48

48

48

48

48

48

48

48

48

48

48

48

48

48

48

48

48

48

48

48

48

48

48

48

48

48

48

48

48

48

48

48

48

48

48



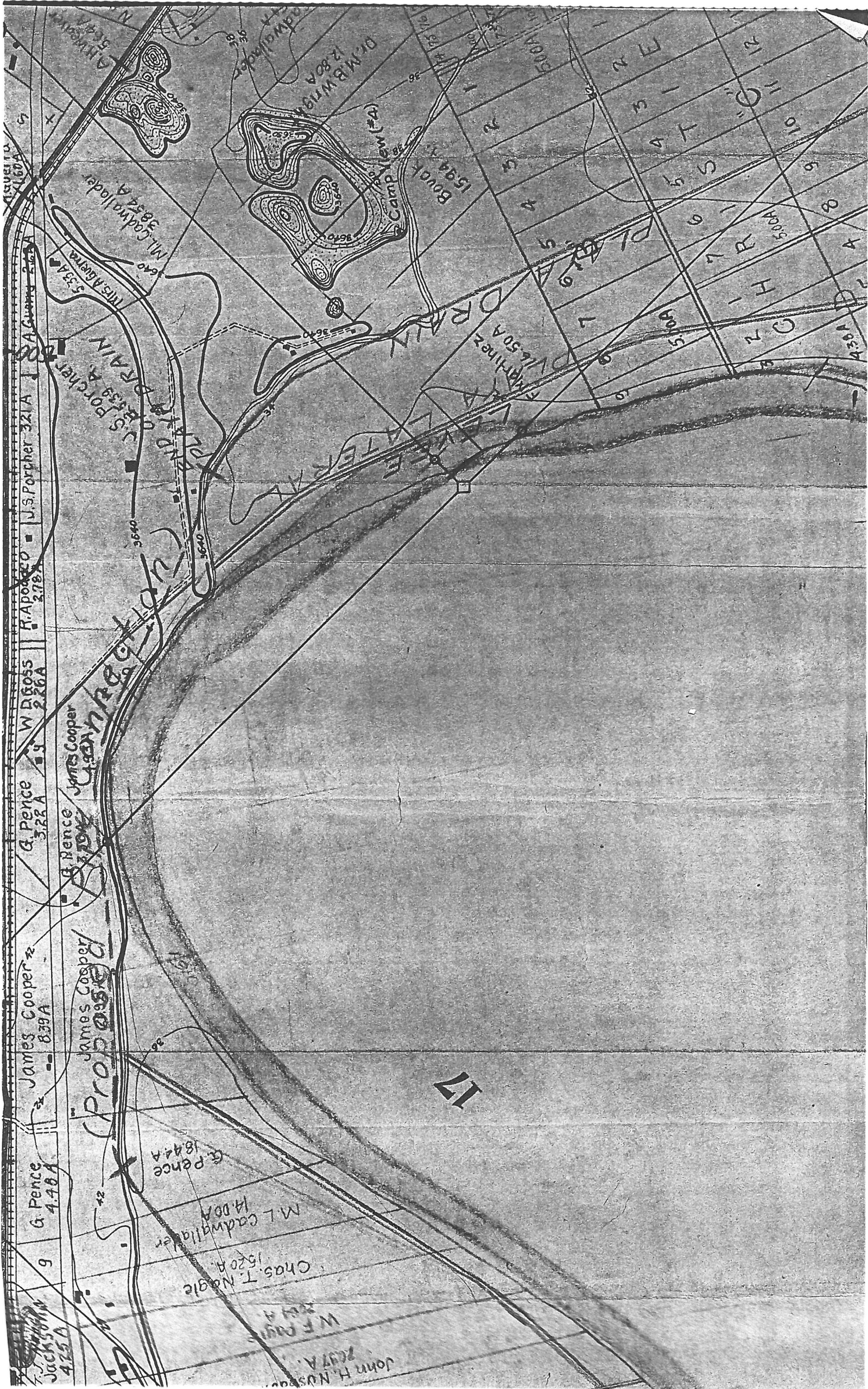

James Cooper 839A
G. Pence 4.48A
G. Pence 3.88A
W. D. Goss 2.26A
R. A. Pophar 321A
U.S. Pophar 3.78A
A. Guera 2.62A
M.L. Cadmyllader 14.00A
Chas. T. Noble 15.20A
W.F. Pugh 25.4A
John H. Nussba 23.7A

James Cooper
G. Pence
M.L. Cadmyllader
Chas. T. Noble
W.F. Pugh
John H. Nussba
C.S. Porcher 308
M.L. Cadmyllader 5.33A
M.L. Cadmyllader 12.80A
D.M.B. Wm 15.94A
C. B. Wm (#4)
M.L. Cadmyllader 36.70
D.V. K. 50A
F. Martinez

17
WATERWAY
DRAIN
NE
S
A
T
5
1
0
10
8
A
4
2
3
4
5
6
7
8
9
10
5
1
2
3
4
5
6
7
8
9
10
11
12
13
14
15
16
17
18
19
20
21
22
23
24
25
26
27
28
29
30
31
32
33
34
35
36
37
38
39
40
41
42
43
44
45
46
47
48
49
50
51
52
53
54
55
56
57
58
59
60
61
62
63
64
65
66
67
68
69
70
71
72
73
74
75
76
77
78
79
80
81
82
83
84
85
86
87
88
89
90
91
92
93
94
95
96
97
98
99
100