

PETITION (2 Vols.) SALITRAL LATERAL

81 83 85 87
15-(44), 17-(37), 19-(31), 21-(54) Texas

RIO GRANDE PROJECT

A PETITION

For the

ENLARGEMENT, RECONSTRUCTION AND EXTENSION

Of the

SALATRAL-CLINT LATERAL SYSTEMS

By the

UNITED STATES RECLAMATION
SERVICE.

10
B-45

Neale leather
SOB RECONSTRUCTION PROJECT

El Paso County Water Improvement District No. 1.

El Paso County, Texas.

A PETITION

For the

ENLARGEMENT, RECONSTRUCTION AND EXTENSION

Of the

SAJALRAL-CLINT LATERAL
SYSTEMS

By

THE UNITED STATES RECLAMATION SERVICE

From the landowners and water users in said District receiving irrigation water for their lands through said lateral systems, granting necessary right of way for performing the desired enlargement, reconstruction and extension and approving the plans therefor subject to the clauses and conditions stated in the petition.

P E T I T I O N.

For the Enlargement, Reconstruction
and Extension of the Salatral and
Clint Lateral System.

State of Texas,)
) SS.
County of El Paso.)

KNOW ALL MEN BY THESE PRESENTS That:

WHEREAS, we the undersigned owners of land and water users securing water for irrigation through the Salatral and Clint Lateral Systems, located in the County of El Paso, State of Texas, realizing that the two main laterals serving the area in which our lands are located, namely, the Clint and Salatral laterals, are insufficient in capacity to adequately and efficiently deliver the proper amount of irrigation water for the most beneficial irrigation of all the lands under said systems, and

WHEREAS, the banks of the present ditches are not of sufficient strength to prevent frequent breaks, causing damages to crops and delays in irrigation deliveries and as the alignment of said ditches can, in many places be improved, and the general grade be raised to more efficiently deliver irrigation heads to the higher lands, and

WHEREAS, there is badly needed an extension of these two laterals for the purpose of allowing the waste water to find its way back to the river, we

NOW, THEREFORE, hereby petition the United States Reclamation Service to carry out such necessary construction and renewals in accordance with plans formulated or hereafter to be formulated by engineers of the Service, under the provisions of the Act of Congress approved June 17, 1902 (32 Stat. 588) and Acts amendatory thereof, and pursuant to contract dated June 15, 1920, between the Secretary of the Interior and the El Paso County Water Improvement District No. 1, for the construction of irrigation and drainage works in said District.

FOR AND IN CONSIDERATION of the benefits to be derived from said improvements, we hereby agree to transfer to the United States, when requested to do so, by quitclaim deed or other instruments, the necessary additional and new right of way for carrying out said enlargement, reconstruction and new construction work on said lateral systems. It is understood that the United States will repair and rebuild all existing fences along the lines of the present laterals when during the course of work it becomes necessary to either temporarily remove or to set them out on the new right of way line.

Attached and made a part of this petition is a map showing general layout of the proposed combined Salatral and Clint Laterals profiles showing proposed section and grades of the new and reconstructed laterals and also a preliminary estimate showing the estimated probable cost of the proposed work. It is not to be assumed that the entire plan of construction or reconstruction can be accomplished during the present winter season of 1920-21 unless sufficient construction forces are available to accomplish the work before the beginning of the coming irrigation season and sufficient satisfactory bids received to permit the work to be done within the estimated cost but it is desired that a comprehensive plan for the final completion of said enlargement, reconstruction and extension, as rapidly as funds and forces will permit, be considered and same is hereby approved in order that the work may progress as rapidly as possible until its final accomplishment is realized.

WITNESS, our hands and seals this day of A. D. 1920.

First Pair of law
 By James P. Frost
 I Sam Carr

in regard with
 under long water for
 about irrigation
 Feb. 10 1921. H. B. West

J. A. McLaughlin
Sam C. Palmer
John L. Lugin
A. T. Lugin
Mrs. A. S. Priest
Ramon Aris
A. J. Remm

Rev. Am. Robertson
J. A. Hicks
W. S. Knox
Wm. W. Shaw
W. C. Porter Given 25x 80 off

Blank lined page with 20 horizontal lines.

Blank lined page with 20 horizontal lines.

Signed up on other petition ^{12/18}

First Ranch Co

C. N. Bassett.

Sam Carr

H. R. Trent.

J. a Mc Gonegall

Sam C. Celum

John Celum

A. T. Celum

Mrs A. S. Priest

Ramon Arias

A. J. Renn.

Wanted

Wanted

J. A. Hicks Lynchville

J. A. Falvey city

A. Krakauer

H. H. Schutz ^{State Capitol, Oklahoma City}

Capels - Co J. L. Marrs Co

J. A. Dick city

I. G. Gaal city

A. Schwartz Popular

C. M. Harver Security Bank

Z. W. Sorrels city

M. Cadwallader

Mrs. V. N. O'Neil

5628 Reiger Ave, Dallas, Tex

J. M. Wyatt city

Julian Bassett

J. V. Schairer Clint

{Bowington Est.

Mrs Elizabeth Bowington 3116 Alamo St City

UNITED STATES RECLAMATION SERVICE

DEPARTMENT OF THE INTERIOR

Signers on other Petition
12/18

Newman Investment Co

K.C. Sparks

D.N. Reid

S.D. Blain

Chas T. Sharp

Julius Krakauer

State of Texas, |
County of El Paso, |

KNOW ALL MEN BY THESE PRESENTS: That we, the undersigned owners of water rights in the Salitral community ditch, for and in consideration of the benefits to accrue to us, respectively, by reason of the reconstruction, enlargement and improvement of a portion of the said Salitral community ditch system to be hereafter performed by the United States of America, hereby disclaim and release all our right, title and interest in and to that portion of the said Salitral ditch system shown upon blueprint attached hereto and made a part hereof, and agree that the United States, pursuant to the Act of Congress approved June 17, 1902 (32 Stat., 388) and acts amendatory thereof and supplementary thereto, may take charge of, operate, maintain and control that portion of said Salitral community ditch system described and all appurtenances thereof, together with that part of the San Elizario community ditch system which is used jointly between the said San Elizario, Clint and Salitral community ditch systems, and shall have the right to reconstruct, enlarge and otherwise improve the same in any manner deemed necessary by the proper officers of the United States in order that there may be afforded superior facilities for the irrigation of the lands tributary thereto.

Witness our hands this.....day of.....A.D. 1917.

W. M. Thomson

Mary F. Thomson

Sam. C. C. C.

Joseph Silva

S. G. Schärer

A. T. C. C.

J. J. Schärer

Albert, H. C. C.

Lamar Aves

The State of Texas,)
County of El Paso.)

KNOW ALL MEN BY THESE PRESENTS: THAT we, L.R. Thomson,

J. J. Schainer and M. Jungjohann, duly elected,

qualified and acting Commissioners of the Salitral Community Ditch, of the County of El Paso, State of Texas, for and in consideration of the sum of One Dollar (\$1.00) to us in hand paid by the United States of America, acting pursuant to the Act of Congress of June 17, 1902, (32 Stat., 386) and other good and valuable considerations, the receipt whereof is hereby acknowledged, do by these presents Bargain, Sell, Release and Forever Quit-Claim, unto the said United States of America, its successors and assigns, all the right, title and interest of the said Salitral Community Ditch in and unto that certain portion of the Salitral Ditch lying in the County of El Paso and State of Texas, from the point of its diversion from the San Elizario Ditch to the point of its intersection with the Franklin Canal, more particularly described in blue print hereto attached and made a part hereof; also all interest of said Salitral Community Ditch in and to that part of the San Elizario Ditch system used jointly by the Salitral, San Elizario and Clint Ditches.

TO HAVE AND TO HOLD all the right, title, interest, estate and claim of the said Salitral Community Ditch in and to the said premises, together with all and singular, the rights, privileges and appurtenances to the same in any manner belonging, unto the said United States of America, its successors and assigns forever; Provided: That nothing herein contained shall be construed as a conveyance, interference with or in any wise affecting the vested right of any holder of rights in the said Salitral Ditch to the use of water from the Rio Grande.

This deed shall become effective to transfer the above described property and rights upon the approval of the Secretary of

the Interior or the Director and Chief Engineer of the U. S. Reclamation Service.

WITNESS our hands this the 13th day of January.

A. D. 1917.

Witness at Request of Grantor:

L. R. Thomson

J. J. Schainer

M. Jungheim

Commissioners of the Saltral
Community Ditch.

APPROVED _____

The State of Texas,)
County of El Paso.)

Before me, James E. Bowen, a Notary Public in
and for El Paso County, Texas, on this day personally appeared
L.R. Thomson, J.J. Schainer and M. Jungjohann,
Commissioners of the Salitral Community Ditch, and acknowledged that
the foregoing instrument was signed by them on behalf of the said
Salitral Community Ditch by authority upon them duly conferred, and
the said L.R. Thomson, J.J. Schainer and
M. Jungjohann, Commissioners of the said Salitral Community
Ditch, acknowledged said instrument to be the free act and deed of
the said Salitral Community Ditch.

Given under my hand and seal of office, this 13th
day of January, A. D. 1917.

(SEAL)

James E. Bowen
Notary Public
El Paso County, Texas

My commission expires June 30, 1917

The State of Texas,)
County of El Paso.)

I, _____, Clerk of the County Court
of said County, do hereby certify that the above instrument of writing,
dated on the _____ day of _____, A. D. 1917, with
its certificate of authentication, was filed for record in my office
this _____ day of _____, A. D. 191_, at _____ o'clock
_____ M. and duly recorded the _____ day of _____, A. D.
191_, at _____ o'clock _____ M. in the records of said county, in
Volume _____ on Pages _____

Witness my hand and the seal of the County Court of said
County, at office El Paso, Texas, the day and year last above written.

Clerk County Court, El Paso County, Texas

By _____, Deputy.

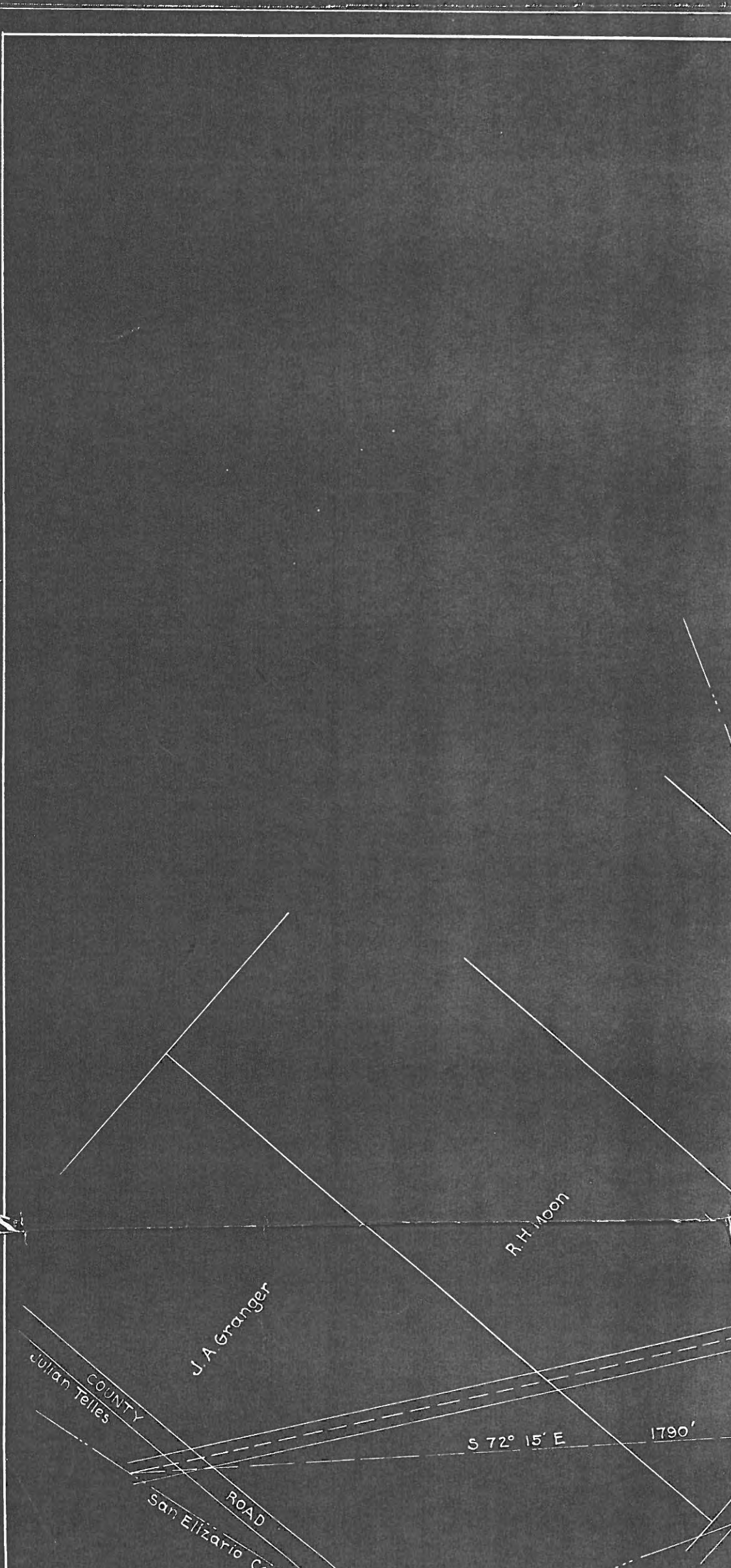

C.O. Coffin

Anderson & Giddings

R.H. Mason

1726

47+26

2550'

S 72° 15' E

1790'

Kelly & Pollard

1920

3029

T.32S R.7E.

Anderson & Gladdings

J. K. Kinnon

C.H. Leavel

Wm Hoffman

S

C.H. Leavel

Geo. Harrison

S 81° 25' E
5344

Wm. Hoffman

20 21
29 28

W. & Mary E. Hood

509

Geo. Harrison

W. & Mary E. Hood

70+70

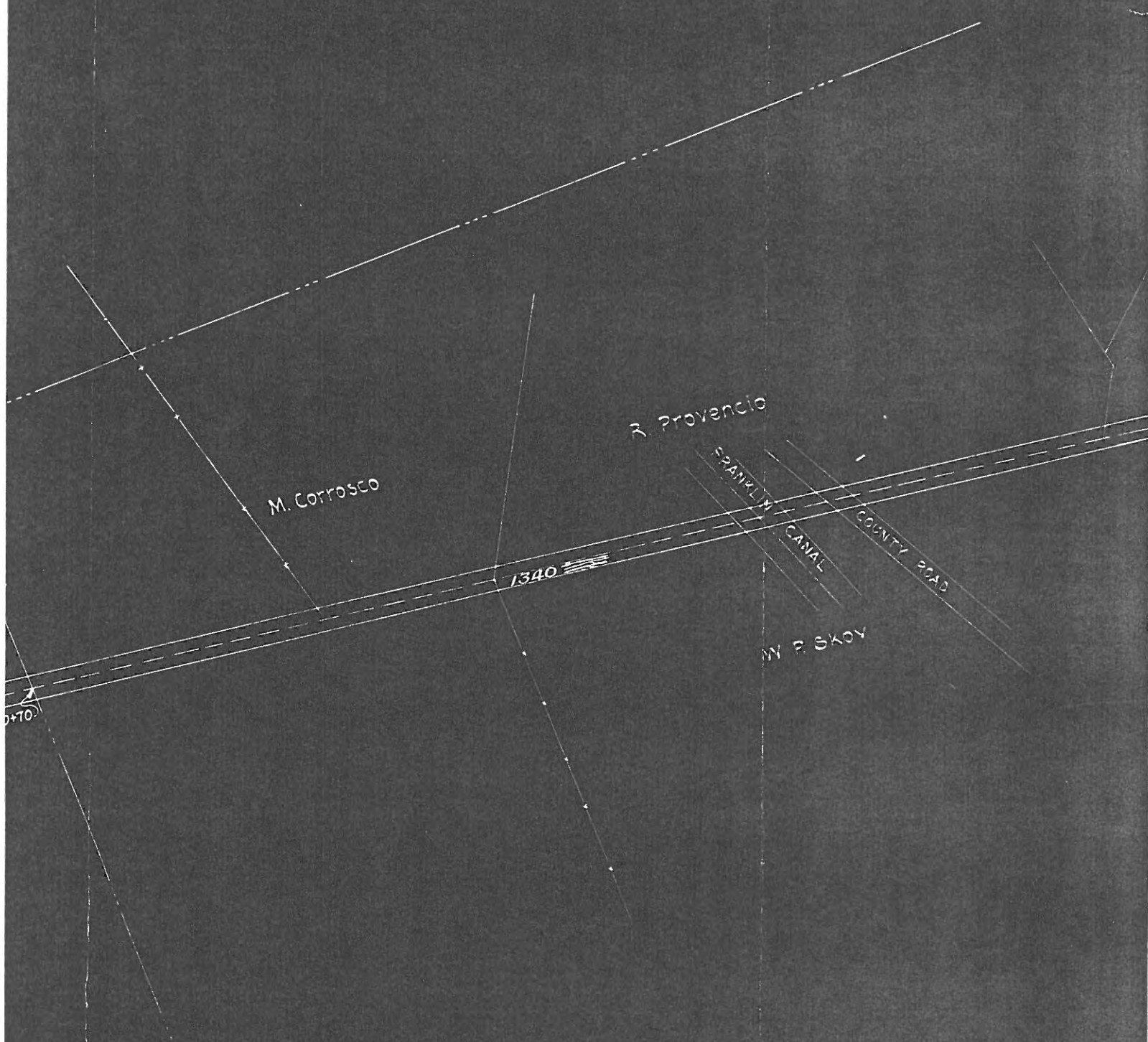

U.S.R.S.
Rio Grande Proj. N.M.-Tex.
Salatral Ditch
El Paso Valley
Scale 1"=200'
Ysleta, Tex. July 1915

Note:
All distances are in feet.

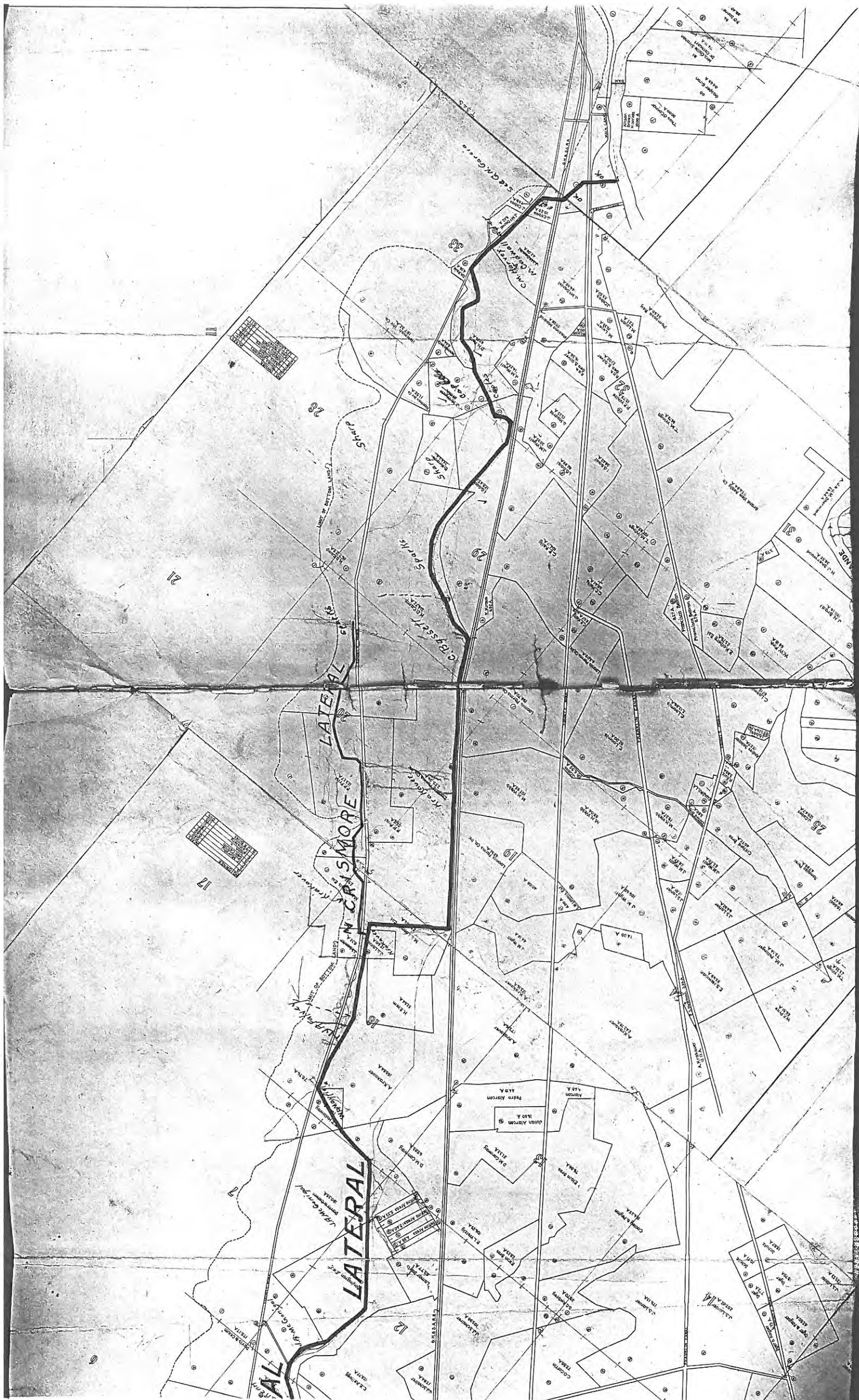

1	2	3	4	5	6	7	8	9	10
11	12	13	14	15	16	17	18	19	20
21	22	23	24	25	26	27	28	29	30
31	32	33	34	35	36	37	38	39	40

1	2	3	4	5	6	7	8	9	10
11	12	13	14	15	16	17	18	19	20
21	22	23	24	25	26	27	28	29	30
31	32	33	34	35	36	37	38	39	40

1	2	3	4	5	6	7	8	9	10
11	12	13	14	15	16	17	18	19	20
21	22	23	24	25	26	27	28	29	30
31	32	33	34	35	36	37	38	39	40

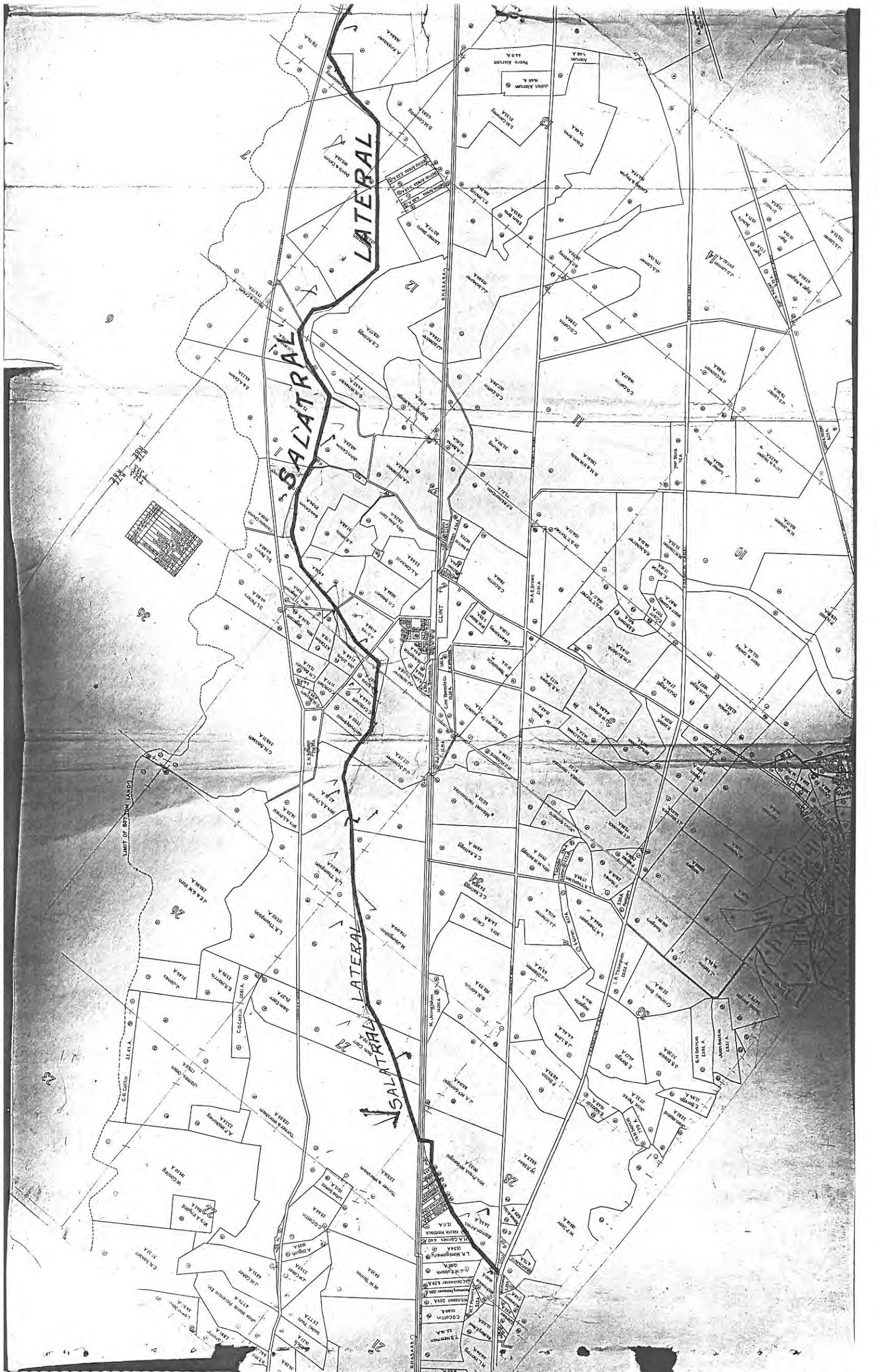

SALATRALL LATERAL

SALATRALL LATERAL

SALATRALL LATERAL

Table with multiple columns and rows, likely a legend or index for the map's features.

LIMIT OF BOTTOM LANDS

SALATRALL LATERAL

SALATRALL LATERAL

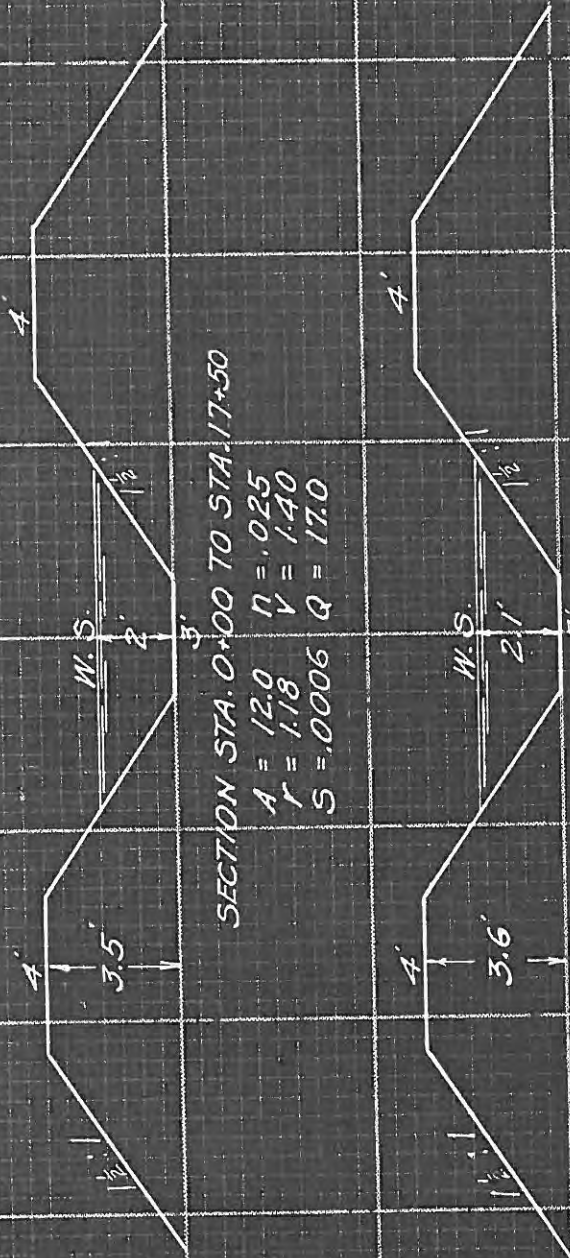
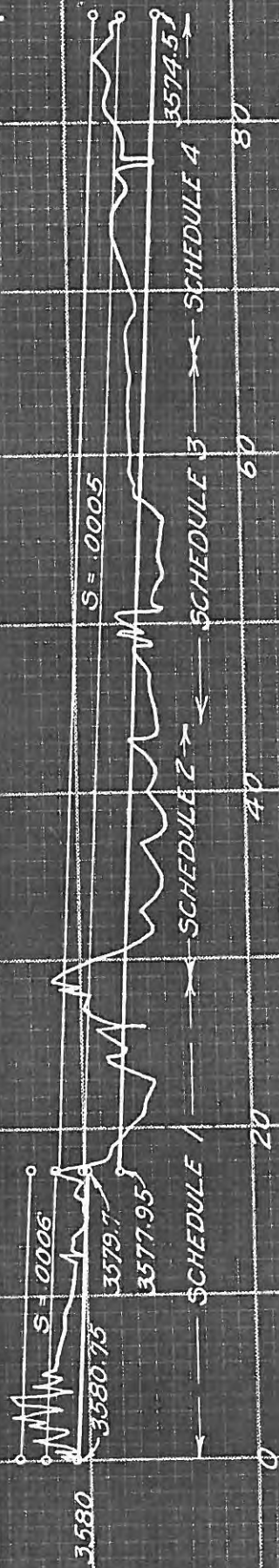

SECTION STA. 0+00 TO STA. 17+50

$A = 12.0$
 $n = .025$
 $r = 1.18$
 $S = .0006$
 $Q = 17.0$

SECTION STA. 17+50 TO STA. 86+47.6

$A = 12.93$
 $n = .025$
 $r = 1.23$
 $S = .0005$
 $Q = 17.0$

DEPARTMENT OF THE INTERIOR
UNITED STATES RECLAMATION SERVICE
RIO GRANDE PROJECT, N.M.-TEX.
EL PASO VALLEY
PROFILE & CROSS SECTIONS
CRISMORE LATERAL

DRAWN A.O.D. RECOMMENDED
CHECKED APPROVED

2109L43 EL PASO, TEX. 12/4/20

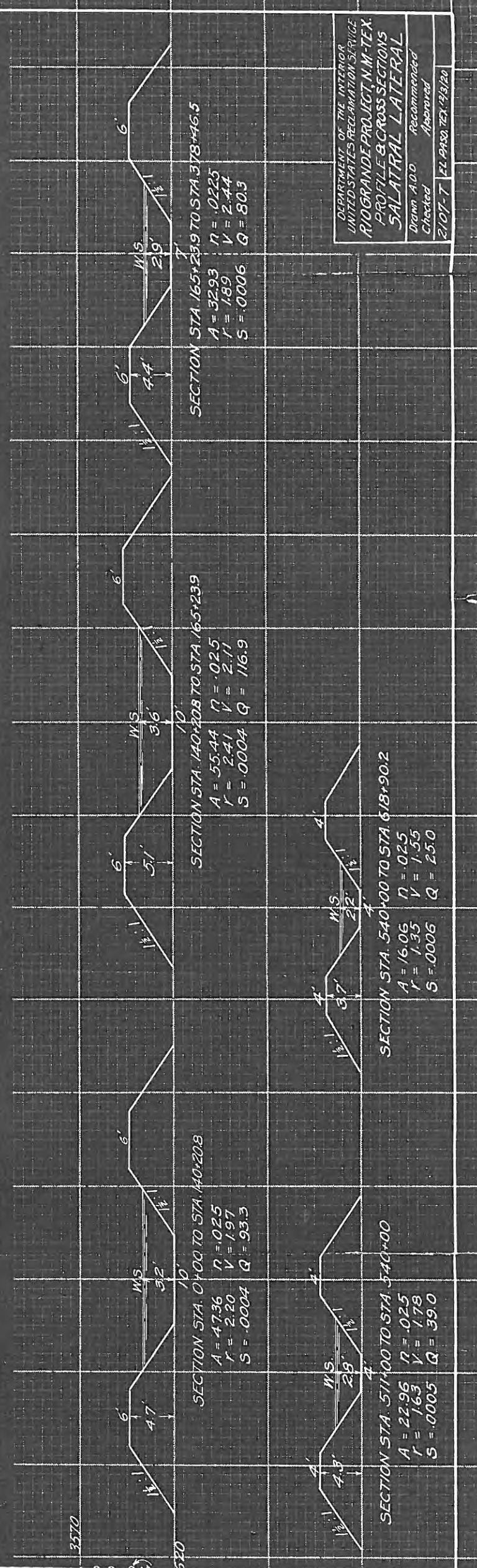
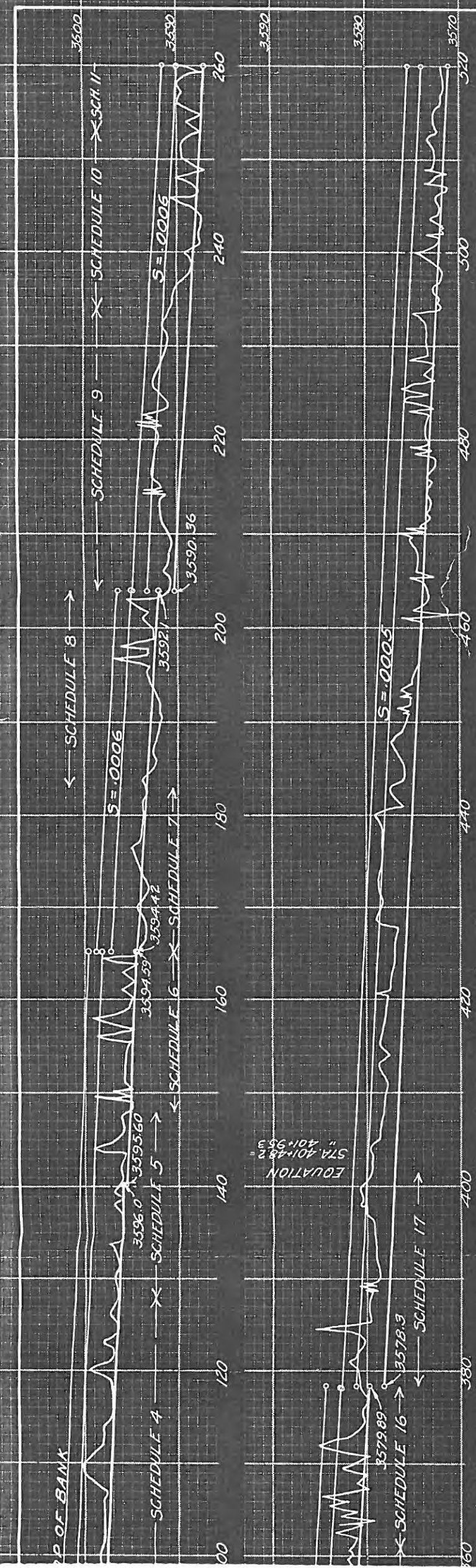

DEPARTMENT OF THE INTERIOR
 UNITED STATES RECLAMATION SERVICE
 RIO GRANDE PROJECT, N.M.-TEX.
 PROFILE & CROSS SECTIONS
 SALATRAL LATERAL
 Drawn A.D.D. Recommended
 Checked Approved
 2107-T PL 9450, EX. 193/20

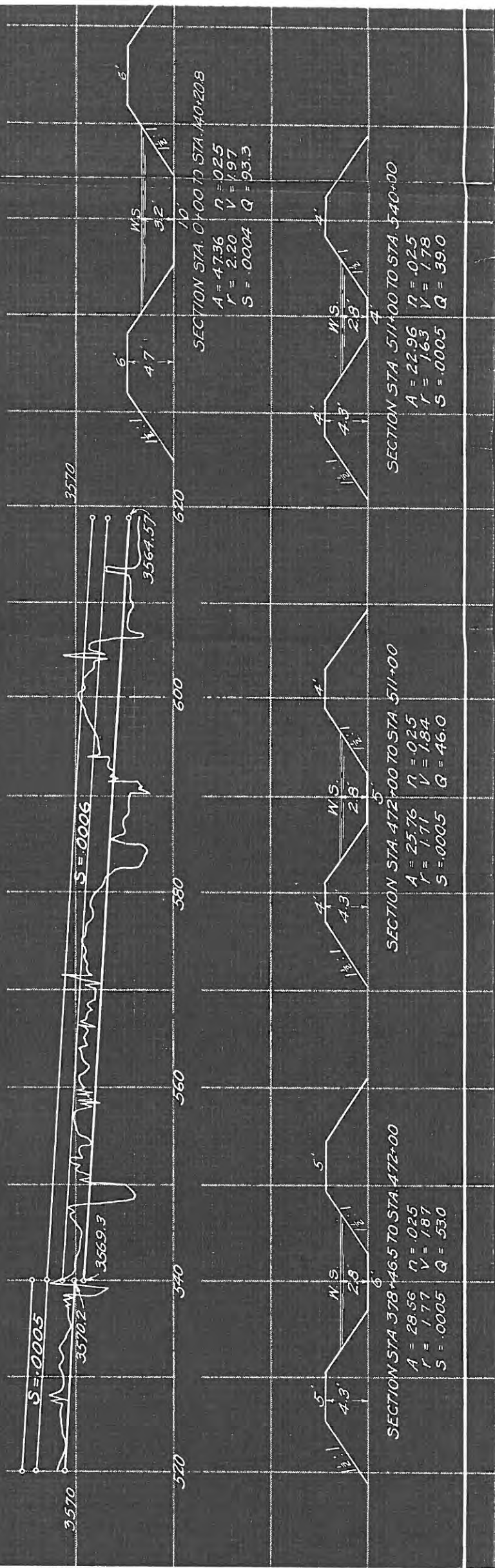
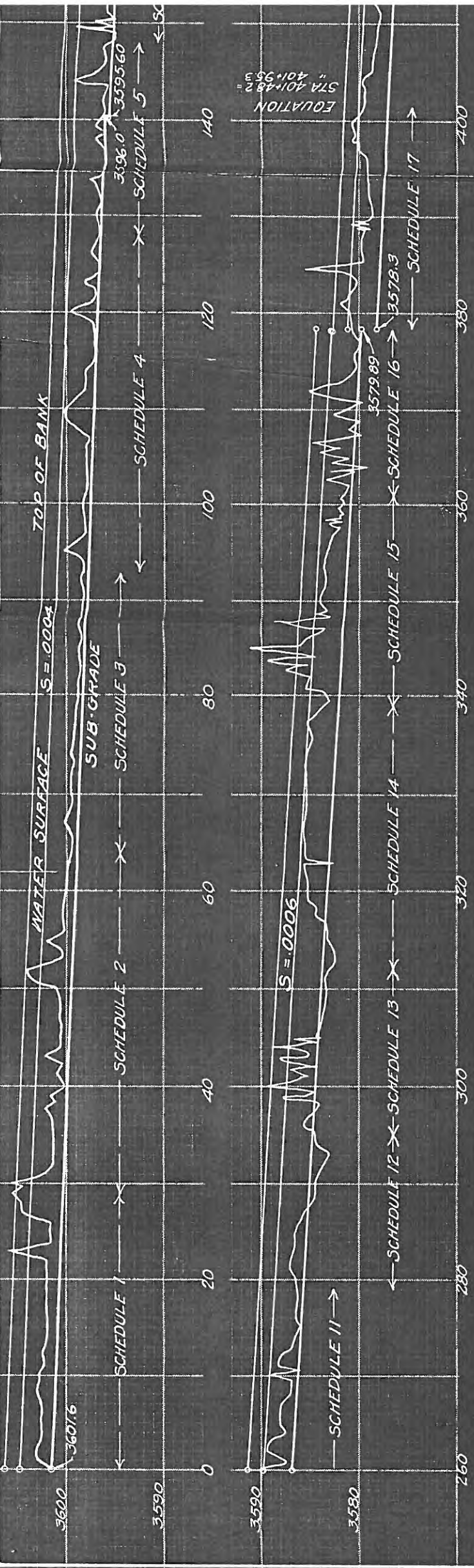

DEPARTMENT OF THE INTERIOR
UNITED STATES RECLAMATION SERVICE

Las Cruces, N. Mex. ~~June 4, 1917.~~

From C. A. Burns, Superintendent of Irrigation,

To Project Manager, El Paso, Texas.

Subject: Salitral Ditch Contract.

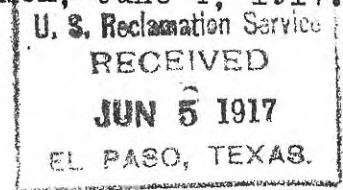

1. Enclosed please find Salitral Ditch Contract sent in error to this office.

C. A. Burns

U. S. Reclamation Service
RECEIVED
JUN 15 1917
EL PASO, TEXAS

DEPARTMENT OF THE INTERIOR
UNITED STATES RECLAMATION SERVICE

U. S. Reclamation Service
RECEIVED
JUN 15 1917
WASHINGTON, D. C.
EL PASO, TEXAS

From Acting Director

June 12, 1917.

To Project Manager, El Paso, Texas.

Subject: Quit claim deed of Jan. 13, 1917, from L. R. Thompson, et al.,
Commissioners of the Salitral Community Ditch, Rio Grande
Project.

*These letters are missing
9/17/17*

1. Enclosed herewith in accordance with your request of
June 2, 1917 is office copy of the above deed, which should have
accompanied office letter of May 21, 1917, in order that the changes
requested therein may be properly indicated on the copy of said deed
and attached blue-print.

2. Please return same to this office as soon as the
desired changes have been made.

-- *Morris Bien*

Enc.

CC: D. C. El Paso.

INSTRUCTIONS.

1. This form is devised to render unnecessary the writing in the Washington office and in the field of various routine letters in reference to contracts.

2. The project or other office where the contract originates will transmit one copy of this form in excess of the number of offices which are to be advised of approval. For example, in the usual case where the project manager and Chief of Construction are to be advised, three copies should be sent to the Washington office.

3. The Chief of Construction will make proper notation on his copy of the contract showing the date when the contract is forwarded by him.

4. Any special matter or information relative to the contract too long to write on the form should be set out in a statement or certificate accompanying the other papers.

5. When reference is made to previous correspondence the dates thereof should be given.

CERTIFICATE

I HEREBY CERTIFY that the community ditch, described in attached deed of January 13, 1917, from the Commissioners of the Salitral Community Ditch, was constructed by a voluntary association of land owners, and that there are no deeds of record conveying to the land owners an easement or right of way for said ditch, and that said ditch has been constructed and in existence for more than the statutory period of limitation, so that title by prescription has been acquired;

That said property is not subject to taxation under the laws of Texas and that neither the tax records nor other county records contain any instruments affording basis of title.

There are no liens against the property

P. W. Dent
District Counsel

El Paso, Texas, April 12, 1917.

DEPARTMENT OF THE INTERIOR
UNITED STATES RECLAMATION SERVICE

El Paso, Texas, April 12, 1917

Project Manager to the Director and Chief Engineer (through Chief of Construction)

Subject: Forwarding ~~contract~~ Quit Claim Deed for approval.

Quit Claim Deed Agreement dated January 13, 1917 Rio Grande Project.

Executed by T. R. Thomson, J. J. Schainer and M. Jungjohann, Commissioners of the Salitral Community Ditch

~~With~~

Estimated amount involved, \$ ---- (See Gen'l Order No. 124)

Purpose of agreement: Donation of ditch property
(See instructions on back, Pars. 4 and 5)

No public notice issued on the Rio Grande Project

~~Original and one copy of bond herewith~~ (Strike out if no bond transmitted.)

Advise Chief of Construction, Denver, Colorado, and Project Manager at El Paso, Texas

and _____ at _____ of the approval of the above.

encs:

- Quit Claim Deed, in duplicate
- 2 certificates of District Counsel, in duplicate

E. H. Baldwin
(Signature.)

(The blanks below to be filled in the Washington Office.)

Approved by

Date of approval

Bond, if any, approved by same officer on same date.

Accepted

Morris Bien,
Acting Director.