

PLAYA INTERCEPTING DRAIN PETITION

A PETITION  
for the  
INTERCEPTING DRAINAGE AND FLOOD PROTECTION  
EMBANKMENT ALONG THE PLAYA LATERAL

STATE OF TEXAS        )  
COUNTY OF EL PASO    )

KNOW ALL MEN BY THESE PRESENTS, That we, the undersigned owners of, or water users on land situate in the County of El Paso and State of Texas and within the boundaries of the El Paso County Water Improvement District No. 1, being desirous of obtaining more secure and dependable protection against floods for our land in the Playa Area, and at the same time to improve the drainage conditions for said lands, do hereby petition for the construction of levee enlargement with borrow to be made from an intercepting drain along the Playa Lateral. The construction to be accomplished by the United States Bureau of Reclamation, with cooperation from the County of El Paso, under the provisions of the Act of Congress approved June 17, 1902 (32 Stat. 388) and acts amendatory thereof and supplementary thereto, and pursuant to a contract dated October 12, 1922 between the Secretary of the Interior and the said El Paso County Water Improvement District No. 1 and a contract dated February 11, 1926 between the United States and the County of El Paso. For and in consideration of the benefits to be derived from the construction of said levee enlargement and the intercepting drain we hereby agree to convey to the United States or to the El Paso County Water Improvement District all the necessary right-of-way required for its proper construction, operation and maintenance across our lands.

The location of the proposed work is shown approximately on the map attached hereto and hereby made a part hereof.

IN WITNESS WHEREOF, we have hereunto affixed our hands and seal this 5<sup>th</sup> day of May 1927.

\_\_\_\_\_  
\_\_\_\_\_  
\_\_\_\_\_  
\_\_\_\_\_  
\_\_\_\_\_  
\_\_\_\_\_  
\_\_\_\_\_

*1/3 of the right of way  
for drain along my east  
line only.*  
*Juan Apodaca*  
*Benigno W. Apodaca*

\_\_\_\_\_  
\_\_\_\_\_

A PETITION  
for the  
INTERCEPTING DRAINAGE AND FLOOD PROTECTION  
ON BANKS OF THE RIO GRANDE ALONG THE PLAYA LATERAL

WARRANT COUNTY )  
COUNTY OF EL PASO )

KNOW ALL MEN BY THESE PRESENTS, That we, the undersigned owners of, or water users on land situate in the County of El Paso and State of Texas and within the boundaries of the El Paso County Water Improvement District No. 1, being desirous of obtaining more secure and dependable protection against floods for our land in the Playa Area, and at the same time to improve the drainage conditions for said lands, do hereby petition for the construction of levee enlargement with borrow to be made from an intercepting drain along the Playa Lateral. The construction to be accomplished by the United States Bureau of Reclamation, with cooperation from the County of El Paso, under the provisions of the Act of Congress approved June 17, 1902 (32 Stat. 338) and acts amendatory thereof and supplementary thereto, and pursuant to a contract dated October 12, 1922 between the Secretary of the Interior and the said El Paso County Water Improvement District No. 1 and a contract dated February 11, 1926 between the United States and the County of El Paso. For and in consideration of the benefits to be derived from the construction of said levee enlargement and the intercepting drain we hereby agree to convey to the United States or to the El Paso County Water Improvement District all the necessary right-of-way required for its proper construction, operation and maintenance across our lands.

The location of the proposed work is shown approximately on the map attached hereto and her by made a part hereof.

IN WITNESS WHEREOF, we have herunto affixed our hands and seal this \_\_\_\_\_ day of \_\_\_\_\_ 1926.

<u>J. F. Coles.</u>	<u>G. R. Heiger</u>
<u>Chas. R. Loomis</u>	<u>Manuel Pedregon</u>
<u>L. J. Clark</u>	<u>Crespin Pedregon</u>
<u>L. J. Lomas</u>	<u>Emilia P. Lomas</u>
<u>Superior Improvement Co.</u>	<u>Chas. A. Z. Lomas</u>
<u>by L. J. Lomas Pres.</u>	<u>W. H. Griggs</u>
<u>Anna Marie Tobin</u>	<u>H. P. ...</u>
<u>H. ...</u>	

A PETITION  
for the  
INTERCEPTING DRAINAGE AND FLOOD PROTECTION  
EMBANKMENT ALONG THE PLAYA LATERAL

STATE OF TEXAS        )  
COUNTY OF EL PASO    )

KNOW ALL MEN BY THESE PRESENTS, That we, the undersigned owners of, or water users on land situate in the County of El Paso and State of Texas and within the boundaries of the El Paso County Water Improvement District No. 1, being desirous of obtaining more secure and dependable protection against floods for our land in the Playa Area, and at the same time to improve the drainage conditions for said lands, do hereby petition for the construction of levee enlargement with borrow to be made from an intercepting drain along the Playa Lateral. The construction to be accomplished by the United States Bureau of Reclamation, with cooperation from the County of El Paso, under the provisions of the Act of Congress approved June 17, 1902 (32 Stat. 388) and acts amendatory thereof and supplementary thereto, and pursuant to a contract dated October 12, 1922 between the Secretary of the Interior and the said El Paso County Water Improvement District No. 1 and a contract dated February 11, 1926 between the United States and the County of El Paso. For and in consideration of the benefits to be derived from the construction of said levee enlargement and the intercepting drain we hereby agree to convey to the United States or to the El Paso County Water Improvement District all the necessary right-of-way required for its proper construction, operation and maintenance across our lands.

The location of the proposed work is shown approximately on the map attached hereto and hereby made a part hereof.

IN WITNESS WHEREOF, we have hereunto affixed our hands and seal this 3<sup>rd</sup> day of May 1927.

James P. James \_\_\_\_\_  
Lawrence C. Thomas \_\_\_\_\_  
W. A. Thomas if all right \_\_\_\_\_  
as now is given by the James \_\_\_\_\_  
was always their own. \_\_\_\_\_  
OK - Thomas \_\_\_\_\_  
B. S. Supts. \_\_\_\_\_

Juan Apodaca

✓ L. Clark

✓ <sup>has TC</sup> C. Loomis

~~F. G. Henley~~ Robt W. Wilmore

L. Clark

Mrs. Tobin

✓ H. H. Stark

T. M. Wingo

Cole Bros.

W. Irwin

Christy Add.

✓ Blk. 5 Lots 4&5 Geiger.

✓ " 4 " 1&2 Mrs. C. A. Miller

*Interurban* " " " ~~3-4-5 L. B. Darnell~~ *Interurban*

" " " 6-7-8-9 Whaley Gilmore 3088

" " " 10 Interurban

Blk: 1 " 10 "

" D 3&6 "

" " 2 R. N. Mullen.

*B.P. B-819 - ...*

*...*

35660  
Rush

DEED  
CONTROLLED ACCESS HIGHWAY FACILITY

THE STATE OF TEXAS  
COUNTY OF El Paso

WHEREAS, the State Highway Commission has been authorized under House Bill 179, Acts of the 55th Legislature, Regular Session, 1957 (Article 6674w-1, et seq., Vernon's Annotated Civil Statutes of Texas) to purchase land and such other property rights deemed necessary for the purposes of facilitating the construction, maintenance and operation of Controlled Access Highways; and,

WHEREAS, the purchase of the hereinafter described premises has been deemed necessary by the State Highway Commission for the purposes of facilitating the construction, maintenance and operation of a Controlled Access Highway facility;

NOW, THEREFORE, KNOW ALL MEN BY THESE PRESENTS:

That, Nettie May Greggerson, a widow (by her son, Vernon L. Greggerson, specially thereto constituted by Power of Attorney dated May 18, 1970 recorded in the Deed Records of El Paso County in Volume 300, Page 0336)

of the County of El Paso, State of Texas, hereinafter referred to as Grantors, whether one or more, for and in consideration of the sum of Thirty-nine thousand eight hundred sixty-five and No/100 (\$ 39,865.00) Dollars, to Grantors in hand paid by the State of Texas, acting by and through the State Highway Commission, receipt of which is hereby acknowledged, and for which no lien is retained, either expressed or implied, have this day Sold, and by these presents do Grant, Bargain, Sell and Convey unto the State of Texas, all that certain tract or parcel of land lying and being situated in the County of El Paso, State of Texas, more particularly described as follows, to wit:

Parcel 266:

Being 293,082 square feet of land, more or less, out of and a part of Tracts 4 and 5B, Block 35, Ysleta Grant, in the City of El Paso, El Paso County, Texas, and being a portion of the same property and all right, title and interest in and to the Playa Drain running through this property, described in the following Deeds: as to Tract 4,; a Warranty Deed from Bertha Stark to H. F. Greggerson dated December 7, 1934, recorded in Volume 593, Page 407; Nettie May Greggerson acquired the property through Probate No. 9848 upon the death of her husband, H. F. Greggerson; as to Tract 5B; a Warranty Deed from Jack D. Tobin to H. F. Greggerson, Sr. dated January 15, 1941, recorded in Volume 680, Page 512; Nettie May Greggerson acquired the property through Probate No. 9848 upon the death of her husband, H. F. Greggerson; all Deeds recorded in the Deed Records of El Paso County, Texas, said 293,082 square feet of land being more particularly described by metes and bounds as follows:

BEGINNING at the point of intersection of the proposed northeasterly right of way line of the Chamizal Border Highway and the northerly line of Tract 4, Block 35, Ysleta Grant, which point bears South 77° 49' 47" West, 1171.43 feet from the northeasterly corner of said Tract 4;

430 1573

THENCE South  $38^{\circ} 55' 45''$  East, 1455.16 feet along the said northeasterly right of way line of the Chamizal Border Highway to a point;

THENCE South  $78^{\circ} 02' 00''$  West, 181.63 feet along the southerly line of Tract 58 to a point;

THENCE North  $40^{\circ} 04' 34''$  West, 935.33 feet along the southwesterly right of way line of the Chamizal Border Highway to a point;

THENCE South  $88^{\circ} 18' 30''$  West, 127.24 feet along the said southwesterly right of way line to a point;

THENCE South  $43^{\circ} 20' 30''$  West, 98.36 feet continuing along said southwesterly right of way line to a point in the existing IBWC right of way line;

THENCE North  $49^{\circ} 13' 09''$  West, 632.31 feet along said IBWC right of way line to a point in the said northerly line of Tract 4;

THENCE North  $77^{\circ} 49' 47''$  East, 69.80 feet along the said northerly line of Tract 4 to a point;

THENCE South  $12^{\circ} 10' 13''$  East, 66.99 feet along the westerly right of way line of the Chamizal Border Highway to a point;

THENCE South  $49^{\circ} 13' 45''$  East, 381.37 feet continuing along said westerly right of way line to a point;

THENCE South  $75^{\circ} 57' 30''$  East, 80.95 feet continuing along said westerly right of way line to a point;

THENCE North  $50^{\circ} 35' 30''$  East, 80.95 feet continuing along said westerly right of way line to a point;

THENCE North  $2^{\circ} 51' 30''$  West, 80.95 feet continuing along said westerly right of way line to a point;

THENCE North  $30^{\circ} 12' 33''$  West, 305.15 feet continuing along said westerly right of way line to a point;

THENCE North  $77^{\circ} 49' 47''$  East, 188.54 feet to the POINT OF BEGINNING, containing an area of 293,082 square feet of land, more or less.

LEVEE BANK.

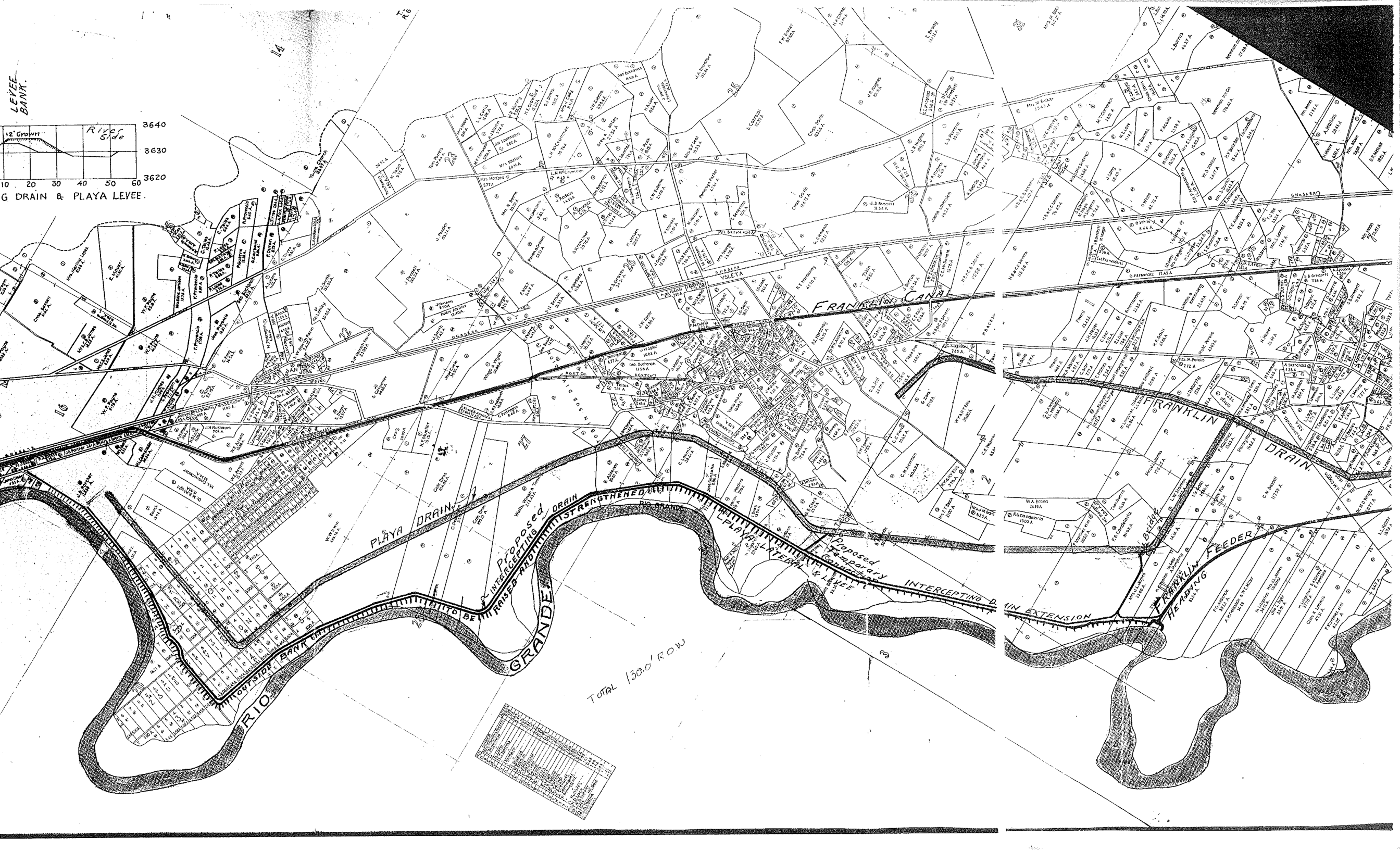
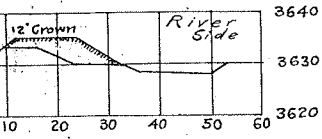

Lot No.	Owner Name	Acreage
1	...	...
2	...	...
3	...	...
4	...	...
5	...	...
6	...	...
7	...	...
8	...	...
9	...	...
10	...	...
11	...	...
12	...	...
13	...	...
14	...	...
15	...	...
16	...	...
17	...	...
18	...	...
19	...	...
20	...	...
21	...	...
22	...	...
23	...	...
24	...	...
25	...	...
26	...	...
27	...	...
28	...	...
29	...	...
30	...	...
31	...	...
32	...	...
33	...	...
34	...	...
35	...	...
36	...	...
37	...	...
38	...	...
39	...	...
40	...	...
41	...	...
42	...	...
43	...	...
44	...	...
45	...	...
46	...	...
47	...	...
48	...	...
49	...	...
50	...	...