

188 MONTVOYA INTERCEPTING DRAIN
~~WHITE INTERCEPTING DRAIN~~

Harvey, Paul et al.

PETITION

0023-0067-0002-00

34-(2) MESTILA

Est. of 77 works

...however the width in feet opposite each of said proposed

KNOW ALL MEN BY THESE PRESENTS, That we, the undersigned
owners of land situate in the County of Dona Ana and State of
New Mexico, and within the boundaries of the Elephant

Butte Irrigation District being desirous of securing
improved adequate and more efficient irrigation, drainage, and flood
protection facilities for our lands in accordance with plans now or

hereafter to be formulated by the United States of America under
provisions of the Act of Congress approved June 17, 1902 (Stat.,
188), and acts amendatory thereof and supplementary thereto, pursuant
to contract dated June 15 1918, and contracts
supplementary thereto between the United States of America and the
said Elephant Butte Irrigation District for and in

consideration of the contemplated benefits to be derived from the con-
struction, reconstruction or improvement and subsequent operation of

irrigation or drainage works or both in the vicinity of our lands; and
in consideration of our mutual promises herein, do hereby agree for
ourselves, our heirs, executors, administrators, successors and
assigns, to convey to the United States of America, by our respective
proper quit claim deeds, upon demand for such deeds being made by the
authorized representatives of the Bureau of Reclamation of the United
States a strip or strips of land for right of way for drainage ditches,
levees and intercepting drains, laterals, connection therewith and
extensions thereof, of such width and length as may be necessary not

Witness my hand and seal this 27 day of March 1927
Without personal liability on the part of
BY EL PASO NATIONAL BANK, Trustee
BY [Signature] ASSISTANT TRUSTEE

[Handwritten signature]
Stewart

Carlton
126 3-5211

... exceed however the width in feet set opposite each of said proposed
works for what are or will be commonly known respectively as follows,
-wit: Montoya Intercepting Drain, 80 feet.

As the same respectively are now or may hereafter be located
and staked out on the ground by the United States acting through the
Bureau of Reclamation, the locations of said drainage ditches, levees
intercepting drains and laterals respectively being approximately
and substantially as shown on the map attached hereto and made a part
hereof.

IN WITNESS WHEREOF, we have hereunto affixed our hands and
seals this 27 day of March 1939

Signed, Sealed and Delivered in
the presence of:

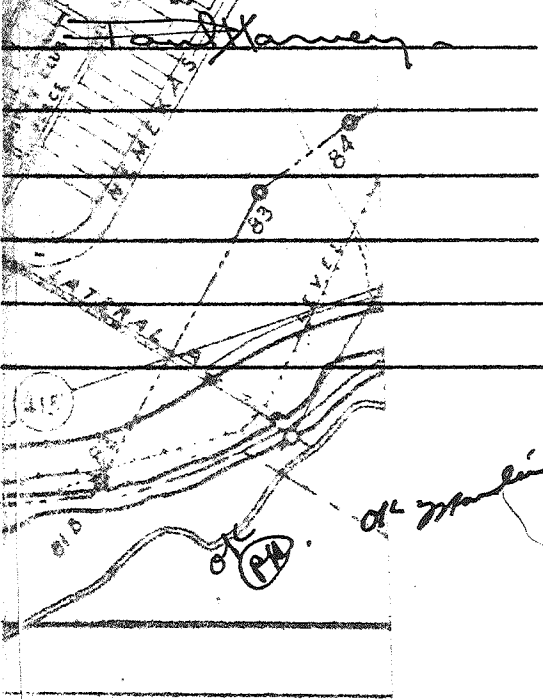

TRUST ESTATE OF Z. T. WHITE & MAUDE B. WHITE
Without personal liability on the part of
El Paso National Bank.
BY EL PASO NATIONAL BANK, Trustee
BY [Signature]
ASSISTANT TRUST OFFICER

of [Signature]

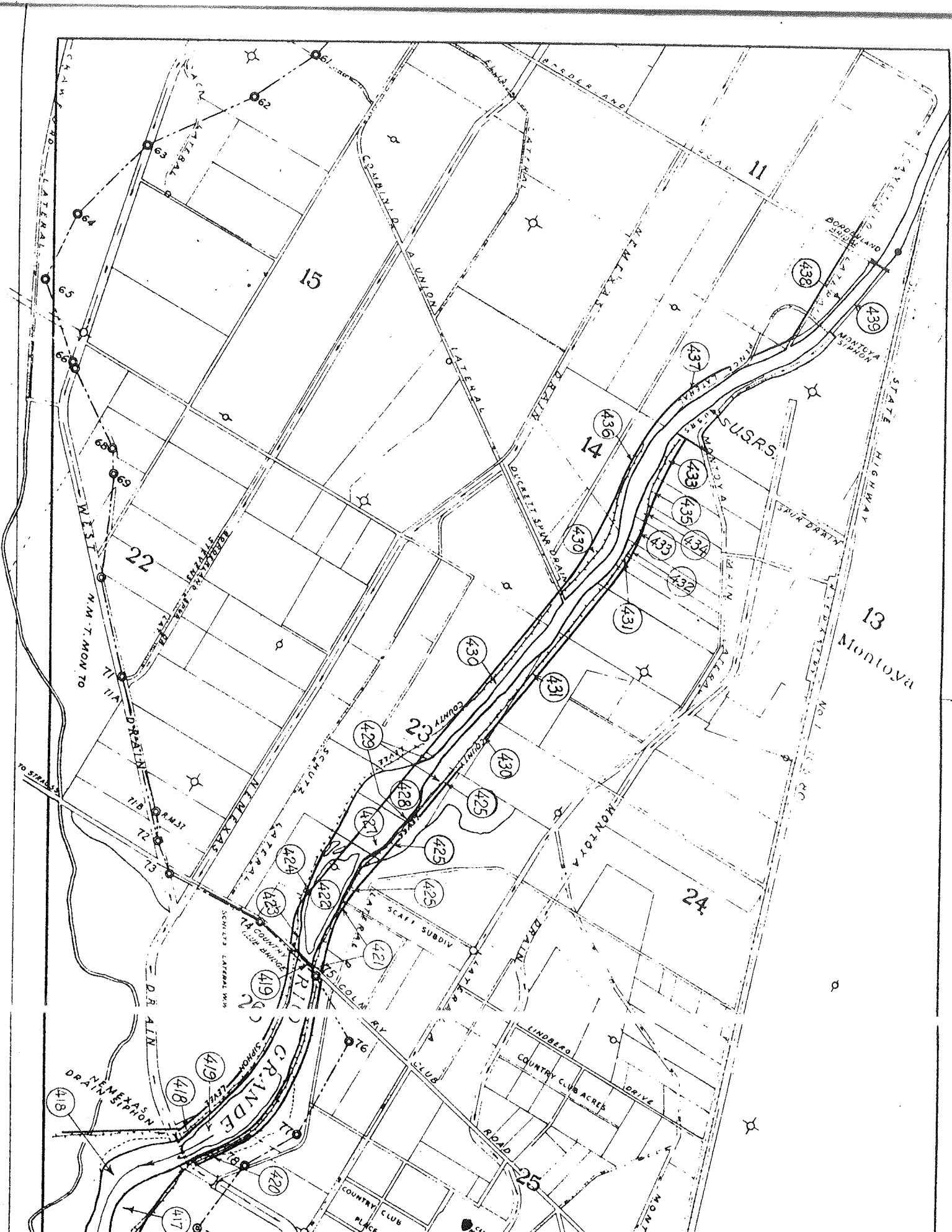

15

11

14

13

22

23

24

25

Montroya

SUSURS

NEMEXAS

GRANDE

LINDBERG COUNTRY CLUB ACRES

STATE HIGHWAY

MONTROYA STATION

WHEELWRIGHT

DECRETT SPUR DRAIN

DRAIN

DRAIN

COUNTRY CLUB

COUNTRY CLUB

CAMP TO LATERAL

LATERAL

LATERAL

DRAIN

DRIVE

DRIVE

SPUR DRAIN

WHEELWRIGHT

ROAD

ROAD

N.M.T. MON TO

DRAIN

DRAIN

DRAIN

DRAIN

DRAIN

DRAIN

DRAIN

DRAIN

DRAIN

DRAIN

DRAIN

DRAIN

DRAIN

DRAIN

DRAIN

DRAIN

DRAIN

DRAIN

DRAIN

DRAIN

DRAIN

DRAIN

DRAIN

DRAIN

DRAIN

DRAIN

DRAIN

DRAIN

DRAIN

DRAIN

DRAIN

DRAIN

DRAIN

DRAIN

DRAIN

DRAIN

DRAIN

DRAIN

DRAIN

DRAIN

DRAIN

DRAIN

DRAIN

DRAIN

DRAIN

DRAIN

DRAIN

DRAIN

DRAIN

DRAIN

DRAIN

DRAIN

DRAIN

DRAIN

DRAIN

DRAIN

DRAIN

DRAIN

DRAIN

DRAIN

DRAIN

DRAIN

DRAIN

DRAIN

DRAIN

DRAIN

DRAIN

DRAIN

DRAIN

DRAIN

DRAIN

DRAIN

DRAIN

DRAIN

DRAIN

DRAIN

DRAIN

DRAIN

DRAIN

DRAIN

DRAIN

DRAIN

DRAIN

DRAIN

61

62

63

64

65

66

67

68

69

70

71

72

73

74

75

76

77

78

79

80

81

82

83

417

418

419

420

421

422

423

424

425

426

427

428

429

430

431

432

433

434

435

436

437

438

439

430

431

432

433

434

435

436

437

438

439

440

441

442

443

444

445

446

447

448

449

450

451

452

453

454

455

456

457

458

459

460

461

462

463

464

465

466

467

468

469

470

471

472

473

474

475

476

477

478

479

480

481

482

483

484

485

486

487

488

489

490

491

492

493

494

495

496

497

498

499

500

501

502

503

504

505

506

507

508

509

510

511

512

513

514

515

516

517

518

519

520

521

522

523

524

525

526

527

528

529

530

531

532

533

534

535

536

537

538

539

540

541

542

543

544

545

546

547

548

549

550

551

552

553

554

555

556

557

558

559

560

561

562

563

564

565

566

567

568

569

570

571

572

573

574

575

576

577

578

579

580

581

582

583

584

585

586

587

588

589

590

591

592

593

594

595

596

