

780. FORD, O.P. ET AL (260)

0023-0086-000F-00
0023-00 - 000L-00

ISLA DITCH

780.

Land Records
Rio Grande Project
(23)

Ford, O. P. et
al

0023-0086-00008-00

0023-0086-00006-00

A Petition
For the Reconstruction and Operation of
ISLA DITCH
ON
The Island of San Elisario

State of Texas)
) ss
County of El Paso)

WHEREAS the Isla Community Ditch is now supplied with water through the main canal system of the El Paso Valley Division of the Rio Grande Project, and is a part of the lateral distribution system in the El Paso County Water Improvement District No. 1, serving more than 150 acres, which makes it subject to the same consideration as given to other laterals of equal importance, is insufficient in capacity to adequately serve all of the land undee it, and is in need of structure renewals, enlargement, and other improvements,

NOW, THEREFORE, We, the undersigned, owners of water rights in the Isla Community Ditch, do hereby petition through our duly organized District that the United States Reclamation Service be requested to take over, reconstruct and enlarge the said Isla Ditch, making it

KNOWN TO ALL MEN BY THESE PRESENTS that for and in consideration of the benefits to accrue to us, respectively, by reason of the reconstruction, enlargement, extension and improvement of the said Isla Community Ditch to be hereafter performed by the United States of America, hereby disclaim and release all our right, title and interest in and to the said Isla Community Ditch as the same is now constructed and in existence, as shown on a map hereto attached and hereby made a part hereof, and agree that the United States, pursuant to the Act of Congress approved June 17, 1902 (32 Stat., 388) and acts amendatory thereof and supplementary thereto, may take charge of, operate and maintain, and control the said ditch system and all appurtenances thereof, during the construction period or until the operation of the Project is taken over by the Irrigation Districts. For the accomplishment of the desired improvements the United States shall have the right to reconstruct, enlarge, extend and otherwise improve the ditch in accordance with plans to be formulated by the engineers of the Reclamation Service. In general said improvements to consist of the enlargement of the ditch to a uniform cross section of sufficient capacity, raising and straightening the banks to standard section, cleaning the banks of all trees, brush and other vegetation, enlarging, renewing, or installing all necessary structures, and making such minor changes in alignment as deemed necessary for the proper maintenance of the ditch, and in further consideration of the benefits to be derived therefrom we agree to convey to the United States or to the El Paso County Water Improvement District No. 1 by quitclaim deed or other proper instrument, if requested to do so, the right of way to be occupied by the ditch as reconstructed or extended.

IN WITNESS WHEREOF, we have hereunto affixed our hands this

29

day of

July

1922.

Oxford

Simon Sanchez

J. M. Escobar

Braulio Soares

C. P. Mills

Juan Sandoz

G. M. Biles

Antonio Lopez

A. P. Bills

Soloa Bonino

Rawley and Dean

Elinor Serrano

Pedra Garcia

Teruo Jurey

John H. H. H.

Crastain Heguin

Severo Cordero Sr

Severo Cordero Jr

Wm Bell

L Lopez

Junior M. Bassett

W. H. Gibson.

Mr. Garrison. C. E.

2

I want to put myself on record as being willing to have the Government do this, for I think it would likely cost less and be in the right place for the main Canal. You could put gates for laterals on each side, and those laterals would reach all irrigable lands. I think, I that I would let you know in time. Before you began to build the main Canal, and put it in working.

Respectfully,

W. H. Gibson.

F. Lewis. Tex.

(1879)
H. M.

Feb. 25. Ex. 4-16th 1875.

Mr. Lawson.

Chief Engineer,

Dear Sir:-

Your Survey No. 61, "Island Tract."
San Eligario Grant. near Febus,
and am now getting some into
Cultivation, and as the Island Ditch,
which has been used a great many
years to irrigate a great portion
of the Island, runs partly on the line
between me and in other No. on the
North. but mostly across my land.
I will give you and Mr. P. R. S. the
written right to go across my land,
with the main Canal, by making it
H. M.

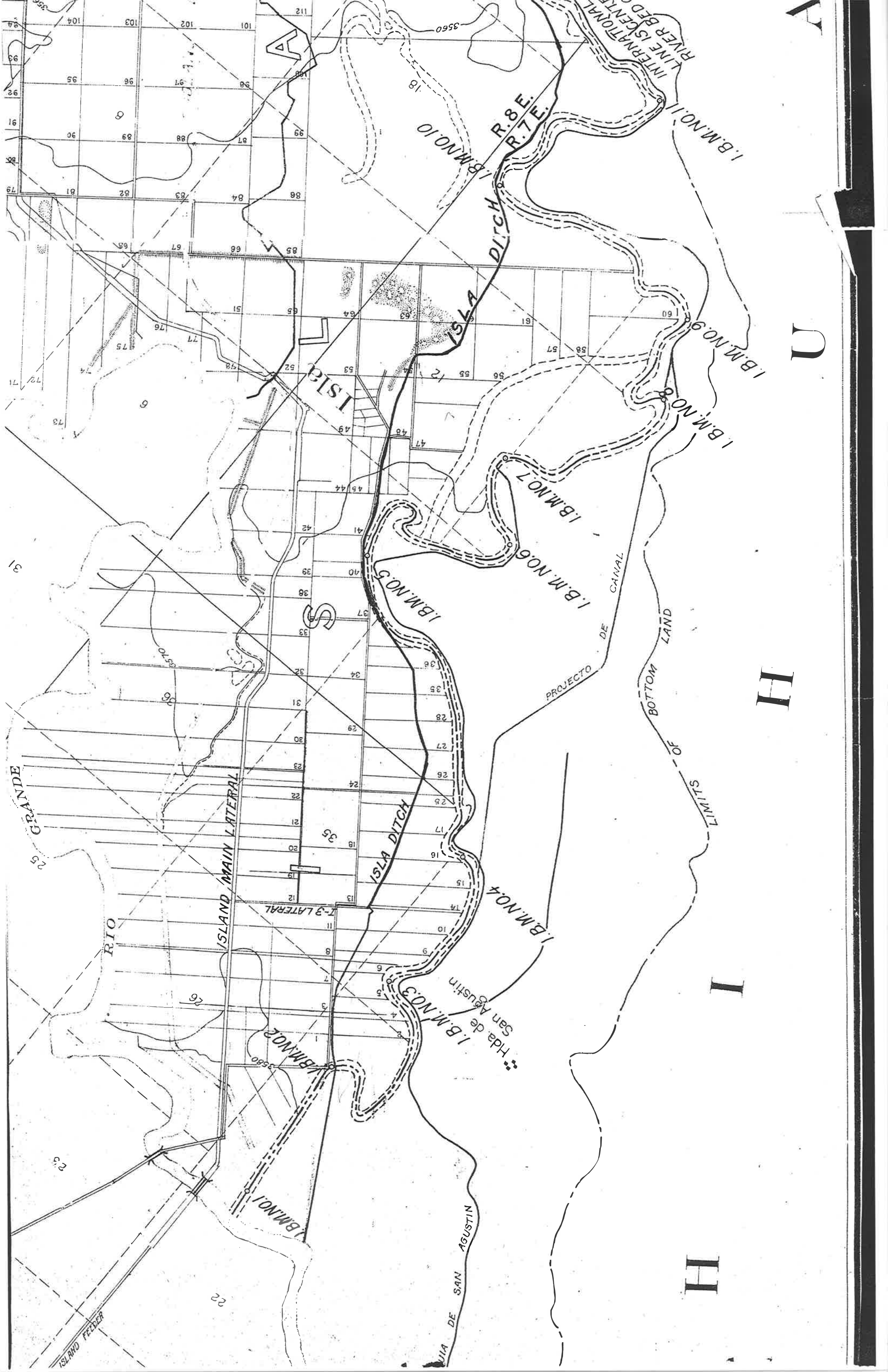

112
101
102
103
104
95
96
97
98
99
87
88
89
90
81
82
83
84
85
86

71
72
73
74
75
76
77
78
60
61
55
56
57
58
59
52
53
54
47
48
49
40
41
42
39
38
37
33
34
35
36
31
30
29
23
24
25
26
27
28

31
32
33
34
35
36
37
38
39
40
41
42
43
44
45
46
47
48
49
50
51
52
53
54
55
56
57
58
59
60
61
62
63
64
65
66
67
68
69
70
71
72
73
74
75
76
77
78
79
80
81
82
83
84
85
86
87
88
89
90
91
92
93
94

1
2
3
4
5
6
7
8
9
10
11
12
13
14
15
16
17
18
19
20
21
22
23
24
25
26
27
28
29
30
31
32
33
34
35
36
37
38
39
40
41
42
43
44
45
46
47
48
49
50
51
52
53
54
55
56
57
58
59
60
61
62
63
64
65
66
67
68
69
70
71
72
73
74
75
76
77
78
79
80
81
82
83
84
85
86
87
88
89
90
91
92
93
94
95
96
97
98
99
100
101
102
103
104

1
2
3
4
5
6
7
8
9
10
11
12
13
14
15
16
17
18
19
20
21
22
23
24
25
26
27
28
29
30
31
32
33
34
35
36
37
38
39
40
41
42
43
44
45
46
47
48
49
50
51
52
53
54
55
56
57
58
59
60
61
62
63
64
65
66
67
68
69
70
71
72
73
74
75
76
77
78
79
80
81
82
83
84
85
86
87
88
89
90
91
92
93
94
95
96
97
98
99
100
101
102
103
104

1
2
3
4
5
6
7
8
9
10
11
12
13
14
15
16
17
18
19
20
21
22
23
24
25
26
27
28
29
30
31
32
33
34
35
36
37
38
39
40
41
42
43
44
45
46
47
48
49
50
51
52
53
54
55
56
57
58
59
60
61
62
63
64
65
66
67
68
69
70
71
72
73
74
75
76
77
78
79
80
81
82
83
84
85
86
87
88
89
90
91
92
93
94
95
96
97
98
99
100
101
102
103
104

ISLA DITCH
R. 8. T. E.
I.B.M. NO. 10
I.B.M. NO. 11
INTERNATIONAL RIVER BED LINE IS CENTRAL

ISLA DITCH
I.B.M. NO. 8
I.B.M. NO. 9
I.B.M. NO. 7
I.B.M. NO. 6
I.B.M. NO. 5
I.B.M. NO. 4
I.B.M. NO. 3
I.B.M. NO. 2
I.B.M. NO. 1

ISLA DITCH
I.B.M. NO. 3
I.B.M. NO. 4
I.B.M. NO. 5
I.B.M. NO. 6
I.B.M. NO. 7
I.B.M. NO. 8
I.B.M. NO. 9
I.B.M. NO. 10
I.B.M. NO. 11

ISLA DITCH
I.B.M. NO. 3
I.B.M. NO. 4
I.B.M. NO. 5
I.B.M. NO. 6
I.B.M. NO. 7
I.B.M. NO. 8
I.B.M. NO. 9
I.B.M. NO. 10
I.B.M. NO. 11

ISLA DITCH
I.B.M. NO. 3
I.B.M. NO. 4
I.B.M. NO. 5
I.B.M. NO. 6
I.B.M. NO. 7
I.B.M. NO. 8
I.B.M. NO. 9
I.B.M. NO. 10
I.B.M. NO. 11

ISLA DITCH
I.B.M. NO. 3
I.B.M. NO. 4
I.B.M. NO. 5
I.B.M. NO. 6
I.B.M. NO. 7
I.B.M. NO. 8
I.B.M. NO. 9
I.B.M. NO. 10
I.B.M. NO. 11

ISLAND MAIN LATERAL
RIO GRANDE
ISLAND FERRER

ISLAND MAIN LATERAL
RIO GRANDE
ISLAND FERRER

ISLAND MAIN LATERAL
RIO GRANDE
ISLAND FERRER

ISLAND MAIN LATERAL
RIO GRANDE
ISLAND FERRER

ISLAND MAIN LATERAL
RIO GRANDE
ISLAND FERRER

ISLAND MAIN LATERAL
RIO GRANDE
ISLAND FERRER

A
D
H
I
H

3560
3570
3580
3590
3600
3610
3620
3630
3640
3650
3660
3670
3680
3690
3700
3710
3720
3730
3740
3750
3760
3770
3780
3790
3800
3810
3820
3830
3840
3850
3860
3870
3880
3890
3900
3910
3920
3930
3940
3950
3960
3970
3980
3990
4000
4010
4020
4030
4040
4050
4060
4070
4080
4090
4100
4110
4120
4130
4140
4150
4160
4170
4180
4190
4200
4210
4220
4230
4240
4250
4260
4270
4280
4290
4300
4310
4320
4330
4340
4350
4360
4370
4380
4390
4400
4410
4420
4430
4440
4450
4460
4470
4480
4490
4500
4510
4520
4530
4540
4550
4560
4570
4580
4590
4600
4610
4620
4630
4640
4650
4660
4670
4680
4690
4700
4710
4720
4730
4740
4750
4760
4770
4780
4790
4800
4810
4820
4830
4840
4850
4860
4870
4880
4890
4900
4910
4920
4930
4940
4950
4960
4970
4980
4990
5000
5010
5020
5030
5040
5050
5060
5070
5080
5090
5100
5110
5120
5130
5140
5150
5160
5170
5180
5190
5200
5210
5220
5230
5240
5250
5260
5270
5280
5290
5300
5310
5320
5330
5340
5350
5360
5370
5380
5390
5400
5410
5420
5430
5440
5450
5460
5470
5480
5490
5500
5510
5520
5530
5540
5550
5560
5570
5580
5590
5600
5610
5620
5630
5640
5650
5660
5670
5680
5690
5700
5710
5720
5730
5740
5750
5760
5770
5780
5790
5800
5810
5820
5830
5840
5850
5860
5870
5880
5890
5900
5910
5920
5930
5940
5950
5960
5970
5980
5990
6000
6010
6020
6030
6040
6050
6060
6070
6080
6090
6100
6110
6120
6130
6140
6150
6160
6170
6180
6190
6200
6210
6220
6230
6240
6250
6260
6270
6280
6290
6300
6310
6320
6330
6340
6350
6360
6370
6380
6390
6400
6410
6420
6430
6440
6450
6460
6470
6480
6490
6500
6510
6520
6530
6540
6550
6560
6570
6580
6590
6600
6610
6620
6630
6640
6650
6660
6670
6680
6690
6700
6710
6720
6730
6740
6750
6760
6770
6780
6790
6800
6810
6820
6830
6840
6850
6860
6870
6880
6890
6900
6910
6920
6930
6940
6950
6960
6970
6980
6990
7000
7010
7020
7030
7040
7050
7060
7070
7080
7090
7100
7110
7120
7130
7140
7150
7160
7170
7180
7190
7200
7210
7220
7230
7240
7250
7260
7270
7280
7290
7300
7310
7320
7330
7340
7350
7360
7370
7380
7390
7400
7410
7420
7430
7440
7450
7460
7470
7480
7490
7500
7510
7520
7530
7540
7550
7560
7570
7580
7590
7600
7610
7620
7630
7640
7650
7660
7670
7680
7690
7700
7710
7720
7730
7740
7750
7760
7770
7780
7790
7800
7810
7820
7830
7840
7850
7860
7870
7880
7890
7900
7910
7920
7930
7940
7950
7960
7970
7980
7990
8000
8010
8020
8030
8040
8050
8060
8070
8080
8090
8100
8110
8120
8130
8140
8150
8160
8170
8180
8190
8200
8210
8220
8230
8240
8250
8260
8270
8280
8290
8300
8310
8320
8330
8340
8350
8360
8370
8380
8390
8400
8410
8420
8430
8440
8450
8460
8470
8480
8490
8500
8510
8520
8530
8540
8550
8560
8570
8580
8590
8600
8610
8620
8630
8640
8650
8660
8670
8680
8690
8700
8710
8720
8730
8740
8750
8760
8770
8780
8790
8800
8810
8820
8830
8840
8850
8860
8870
8880
8890
8900
8910
8920
8930
8940
8950
8960
8970
8980
8990
9000
9010
9020
9030
9040
9050
9060
9070
9080
9090
9100
9110
9120
9130
9140
9150
9160
9170
9180
9190
9200
9210
9220
9230
9240
9250
9260
9270
9280
9290
9300
9310
9320
9330
9340
9350
9360
9370
9380
9390
9400
9410
9420
9430
9440
9450
9460
9470
9480
9490
9500
9510
9520
9530
9540
9550
9560
9570
9580
9590
9600
9610
9620
9630
9640
9650
9660
9670
9680
9690
9700
9710
9720
9730
9740
9750
9760
9770
9780
9790
9800
9810
9820
9830
9840
9850
9860
9870
9880
9890
9900
9910
9920
9930
9940
9950
9960
9970
9980
9990
10000

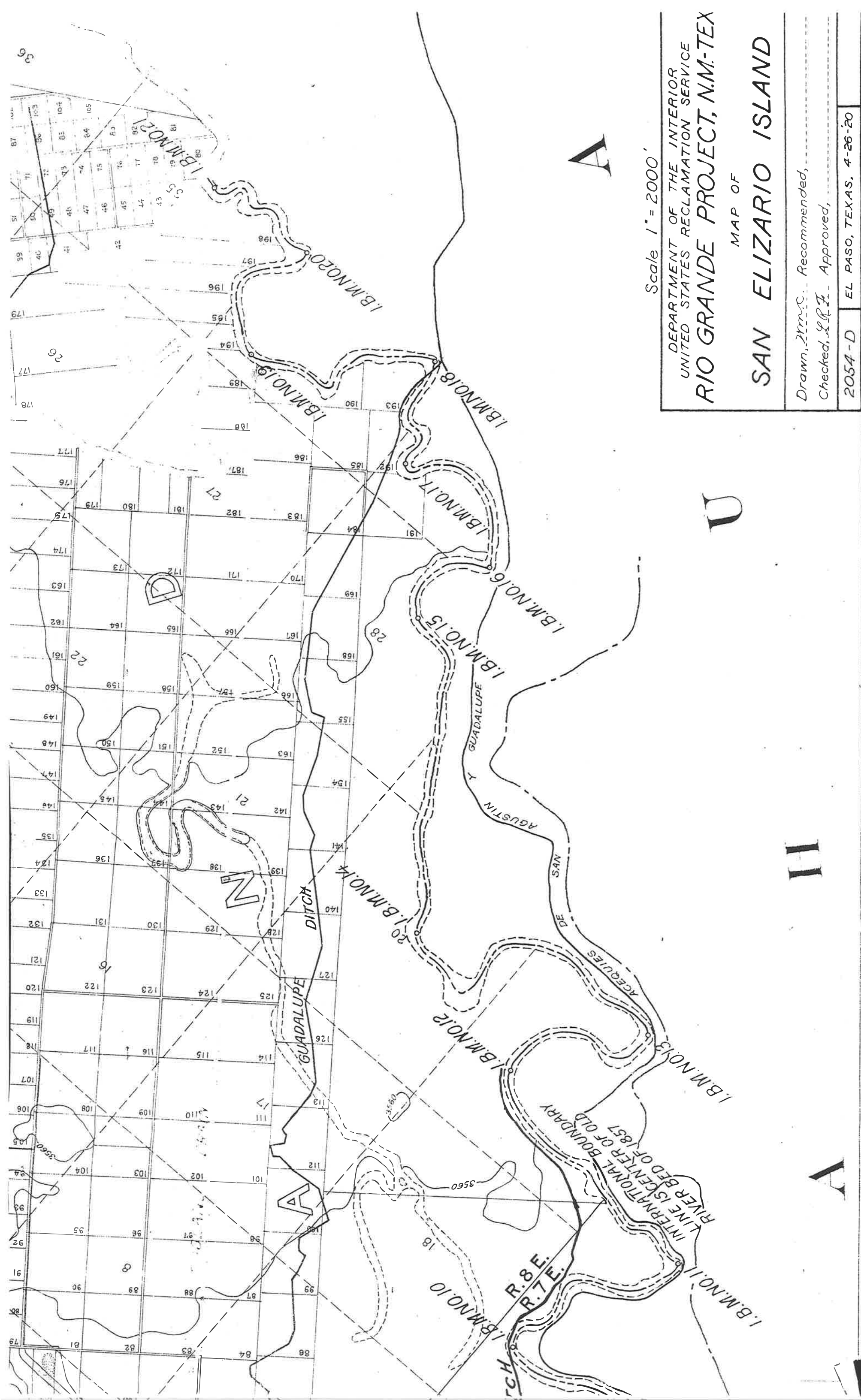

Scale 1" = 2000'

DEPARTMENT OF THE INTERIOR
UNITED STATES RECLAMATION SERVICE

RIO GRANDE PROJECT, N.M.-TEX

MAP OF

SAN ELIZARIO ISLAND

Drawn, *Wm.C.* Recommended,
Checked, *L.R.F.* Approved,

2054-D EL PASO, TEXAS. 4-26-20

II

A