

State of Texas )  
 ) ss  
County of El Paso )

WHEREAS the cultivated and irrigated area on the Island of San Elisarie is rapidly increasing demanding and requiring extensions and enlargements of the irrigation facilities and

WHEREAS the irrigation ditch known as the Hansen Community Ditch is so located in part that it logically forms a part of the general plan for the complete irrigation system and whereas it must be enlarged, raised and extended to adequately serve the lands coming under it

NOW, THEREFORE, We, the undersigned owners of ditch rights in the Hansen Community Ditch, do hereby petition through our duly organized Irrigation District, that the United States Reclamation Service take over, reconstruct, enlarge and extend said Hansen Community Ditch, making it

KNOWN TO ALL MEN BY THESE PRESENTS that for and in consideration of the benefits to accrue to us, respectively, by reason of the improvements and operation of said Hansen Community Ditch to be hereafter performed by the United States of America in accordance with the provisions of the Act of Congress approved June 17, 1902 (32 Stat., 388) and acts amendatory thereof or supplementary thereto, and in pursuance of contract with the El Paso County Water Improvement District No. 1, we hereby disclaim and release all our rights, title and interest in and to said Ditch as same is now constructed and in existence, as shown on a map attached hereto and hereby made a part hereof, in order that it may be taken over by the United States Reclamation Service to be reconstructed, enlarged, extended and otherwise improved to be incorporated in the general plan for the complete Irrigation system as formulated by the engineers of the Reclamation Service, and thereafter operated, maintained and controlled by the United States during the construction period or until the operation of the Project is taken over by the Irrigation Districts. In order that said improvements may be accomplished we agree to convey to the United States or to the El Paso County Water Improvement District by quitclaim deed or other proper instrument, if requested to do so, the necessary right of way to be occupied by the ditch as it is to be reconstructed or extended.

IN WITNESS WHEREOF, we have hereunto affixed our hands this \_\_\_\_\_ day of \_\_\_\_\_ 1922.

<u>W. C. Bickley</u>	#73 { Andrew N. Hansen
<u>L. Harvey</u>	{ W. M. Martin
<u>V. C. Hansen</u> <small>on condition that Bar Pitts be filled</small>	<u>M. J. Delaney</u> Survey 149-160
<u>J. G. Miller</u>	<u>P. P. Harris</u>
<u>E. L. Metzger</u>	<u>David W. Cochran</u>
<u>Tom Nordmark</u> <small>of J. C. Hansen</small>	<u>C. H. Woster</u>
<u>H. E. Griffin</u>	<u>Laura O. O.</u>

Signatures of O'Hara

One Rankin  
Stark Mooravick

81. 3. Austrian

90. H<sup>1/2</sup> O'Neill

79-80 CH Webster -

91. ~~Dave C. Webster~~

154. ~~M. P. Manion~~

94. Duffin

93. Martin T. ...

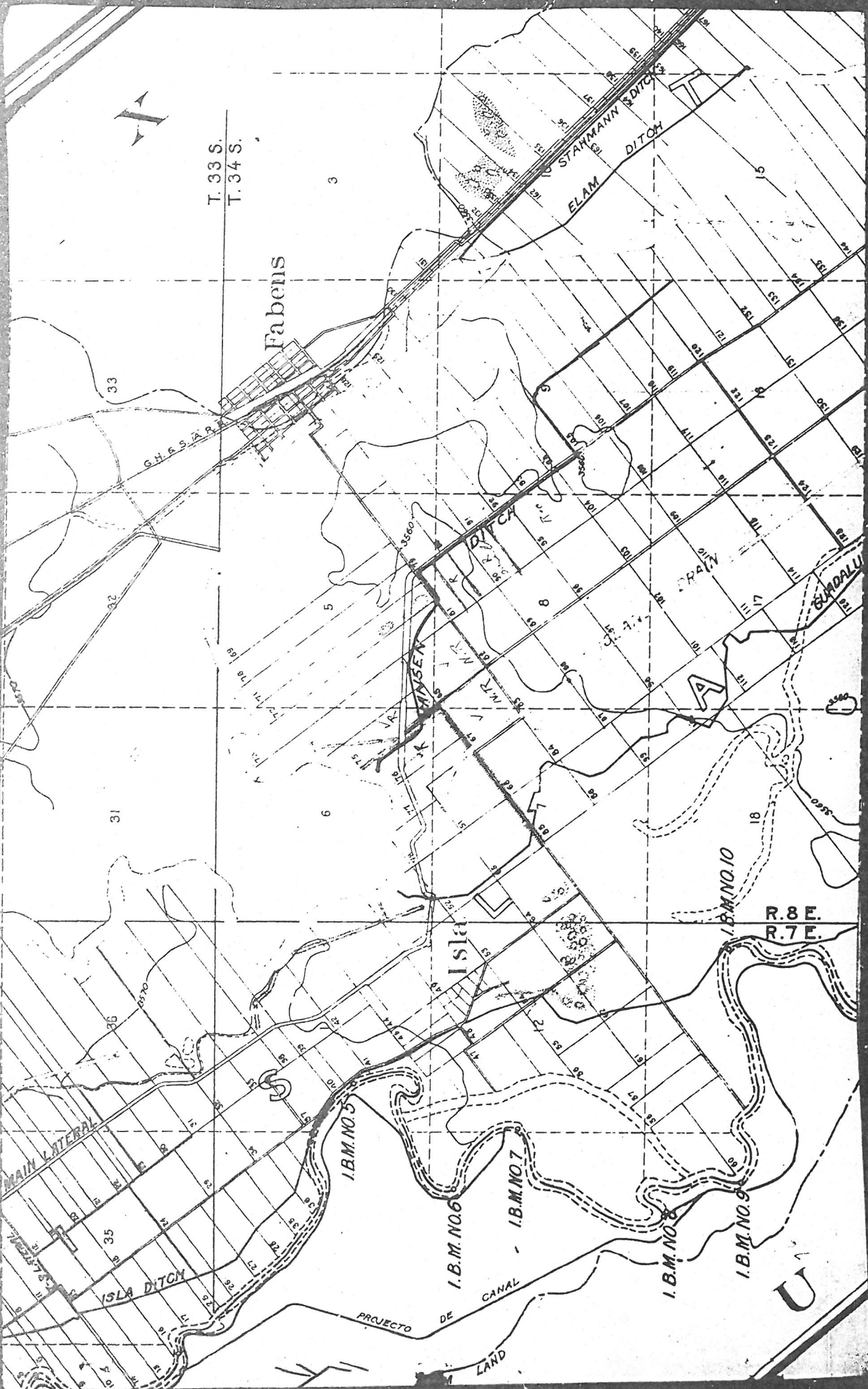

T. 33 S.  
T. 34 S.

Fabens

ELAM DITCH  
STAHMANN'S DITCH

DRAIN

R. 8 E.  
R. 7 E.

ISLA DITCH

I.B.M. NO. 5

I.B.M. NO. 6

I.B.M. NO. 7

I.B.M. NO. 8

I.B.M. NO. 9

I.B.M. NO. 10

PROYECTO DE CANAL

LAND