

C.E. WATERHOUSE
SUR. 6

E. 332'-99.05' 32.95'
Sta. 382+53.9

SUR. 7
S. 5°27'30" W. 2562.2' to SW COR. SEC. 1

SUR. 8

SUR. 9

SUR. 10

BURGES, BURGES & COOLEY

DRAIN 3.09 A.
OLD ROAD 1.01 A.
NEW ROAD 1.00 A.

Q.C.D. 10/22/19
Recorded 10/29/19
Book 335 Pg 169

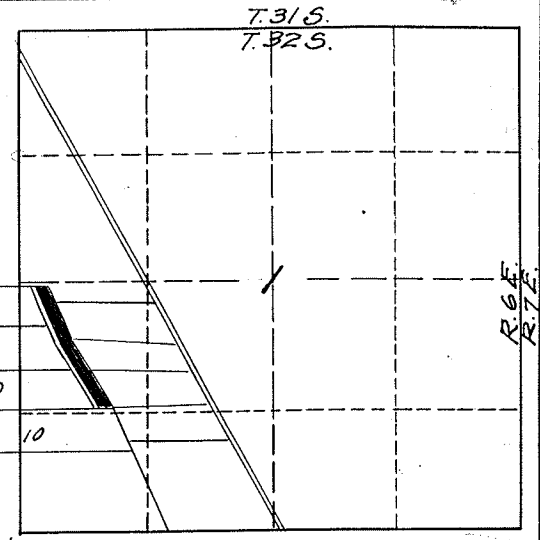

SECTION 1, T. 32 S., R. 6 E., USRS,
SURVEY & SURVEYS 7, 8 AND 9
YSLETA GRANT, EL PASO CO., TEX.

Δ 7°16' R.
D. 2° R.
T. 181.9'
L. 363.3'
Chords 100'

PT. 372+86.2
R. 5679.65'
Δ 9°20' L.
D. 1° L.
T. 467.7'
Chords 100'
R. 5649.65'

382+54
367+92
1462

Scale: 1" = 200'

DEPARTMENT OF THE INTERIOR
UNITED STATES RECLAMATION SERVICE
RIO GRANDE PROJ. N.M. TEX.
EL PASO VALLEY DRAINAGE
FRANKLIN DRAIN RIGHT OF WAY
DRAWN A.D.D. FIELD WORK
CHECKED: APPROVED:
1253 L 53 EL PASO, TEX. JUNE, 19

S. 36°08' W. 1571.8' to SW COR. SEC. 1
T.M. BRS. N 27°16' 35" W.

Sta. 367+92.3 S.T.
W. 128.5'

P.I. 368+20.6'

N. 31°33' W. 193.5'
R. 2914.93'
R. 2944.93'
P.C. 374+80.1

N. 31°33' W. 193.5'
R. 2914.93'

N. 31°33' W. 193.5'
R. 2914.93'

N. 24°01' E. 389.6'
S. 24°01' E. 389.6'
P.T. 378+43.4

N. 24°37' W. 421.2'
S. 24°37' W. 421.2'

N. 24°37' W. 421.2'
S. 24°37' W. 421.2'

S. 24°21' E. 178.1'
S. 24°21' E. 178.1'

S. 24°21' E. 178.1'
S. 24°21' E. 178.1'