

U.S. Federal Land Bank of Wichita

Quitclaim Deed

Anthony Drain. <sup>(003)</sup>

0023-0056-0015-00

782

(STAT.)

# 26900

QUITCLAIM DEED

This Indenture, made the 5th day of June, in the year of our Lord, one thousand nine hundred and forty, between THE FEDERAL LAND BANK OF WICHITA, Wichita, Kansas, a corporation, party of the first part, and the UNITED STATES OF AMERICA, party of the second part, in pursuance of the provisions of the act of June 17, 1902 (32 Stat. 368), and acts amendatory thereof and supplementary thereto.

Witnesseth: That the party of the first part, for and in consideration of the allowance of credits in the sum of Two hundred ten and no/100 Dollars (\$210.00) upon the construction charge assessments of the Elephant Butte Irrigation District against lands of the said party of the first part, pursuant to contract of December 20, 1929, and contract of August 30, 1939, between the said District and the United States, does by these premises demise, release, and forever quitclaim unto the said party of the second part, and to its successors and assigns, all that certain lot, piece, or parcel of land situated in the County of Dona Ana, and State of New Mexico, and bounded and particularly described as follows, to-wit:

Correct as to Engr. Data

A tract of land lying and situate in Dona Ana County, New Mexico, and in the Northwest Quarter (NW $\frac{1}{4}$ ) of Section Four (4), Township Twenty-six (26) South, Range Three (3) East, N.M.P.M., Bureau of Reclamation Survey; being also within tract numbered 1565 as shown on Dona Ana County, New Mexico, Plat Book; more particularly described as follows:

Beginning at a point on the South line of the Northwest Quarter (NW $\frac{1}{4}$ ) of Section Four (4), Township Twenty-six (26) South, Range Three (3) East, N.M.P.M., Bureau of Reclamation Survey and from which point the Southwest corner of said Section Four (4) bears South no degrees (0°) fifty-three minutes (53') thirty-nine seconds (39") West two thousand six hundred forty-four and four tenths (2644.4) feet; thence North no degrees (0°) two minutes (02') West two thousand six hundred eight and four tenths (2608.4) feet to a point from which the Northwest corner of Section Four (4), Township Twenty-six (26) South, Range Three (3) East N.M.P.M., Bureau of Reclamation Survey bears North sixty-two degrees (62°) twenty-nine minutes (29') West fifty and nine tenths (50.9) feet; thence North eighty-nine degrees (89°) fifty-eight minutes (58') East one hundred (100) feet; thence South no degrees (0°) two minutes (02') East two thousand six hundred eight and four tenths (2608.4) feet to the South line of the Northwest Quarter (NW $\frac{1}{4}$ ) of said Section Four (4); thence along said line South eighty-nine degrees (89°) fifty-eight minutes (58') West one hundred (100) feet to the point of beginning. Said tract of land containing six (6) acres, more or less. Shown on plat attached hereto and made a part hereof.

together with all and singular the tenements, hereditaments, and appurtenances thereunto belonging, or in anywise appertaining, and the reversion and reversions, remainder and remainders, rents, issues, and profits thereof.

To Have and to Hold, all and singular the said premises, together with all the appurtenances, unto the said party of the second part, and unto its successors and assigns, forever.

In Witness Whereof, The said party of the first part has caused these presents to be signed by its Vice President, and its corporate seal to be affixed hereto, and attested by its Secretary, by and with the consent and authority of its Board of Directors, on the date and year first above written.

THE FEDERAL LAND BANK OF WICHITA,

By C. G. Shull  
C. G. Shull Vice President

ATTEST:

Guy Fogelberg  
Guy Fogelberg Secretary

OK  
mlh

(ACKNOWLEDGMENT)

STATE OF KANSAS     )  
                          ) SS.  
COUNTY OF SEDGWICK )

Before me, the undersigned, a Notary Public in and for said County and State, on this 5th day of June, 1940, personally appeared *C. G. Hull* to me personally known and known to me to be the identical person who subscribed the name of The Federal Land Bank of Wichita, Wichita, Kansas, a corporation, to the foregoing instrument as its Vice-President, and he being by me duly sworn did say that he is such officer and that the seal affixed to said instrument is the corporate seal of said corporation and that the same was signed and sealed in behalf of said corporation by authority of its board of directors, and he acknowledged to me that he executed the same as his free and voluntary act and deed, and as the free and voluntary act and deed of such corporation, for the uses and purposes set forth and specified therein.

Witness my hand and seal the day and year last above written.

*Minnie B. Hume*  
\_\_\_\_\_  
Notary Public

My commission expires:

April 24, 1941.

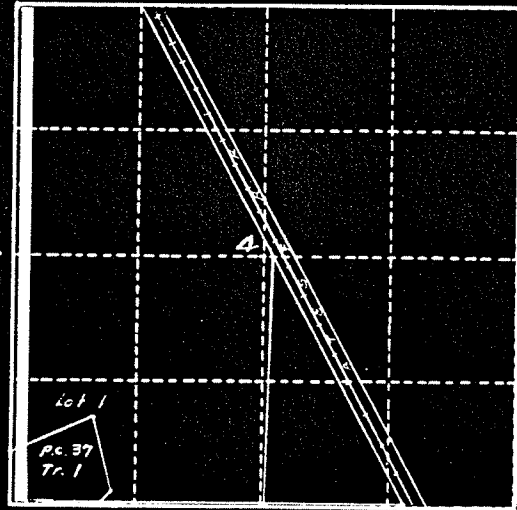

SCALE 1" = 2000'

LOCATION PLAT  
S. 4 T. 265, R. 3E., N.M.P.M.  
U.S.R.S. SURVEY,  
DONA ANA COUNTY, N.M.  
COUNTY PLAT #1565  
PC No 37 Tr 2 ENT. 10-12-14  
PAT. 9-1-15  
NW 1/4 ENT. 4-12-90 PAT. 11-12-94  
LOT 1; NW 1/4 SW 1/4 ENT. 7-27-88 PAT. 11-12-94

N 62° 29' W 50.9'  
To N.W. COR. SEC. 4

N 89° 58' E.  
417+48

N 0° 02' W. 2608.4'

6.0 ACRES

S 0° 02' E. 2608.4'

P.C. 37 - Tr. #1 - 1.5 ACRES  
N.W. 1/4 Sec 4 - 6.0 "  
Total R of W - 7.5 "

SCALE 1" = 300' # 30

DEPARTMENT OF THE INTERIOR  
BUREAU OF RECLAMATION  
RIO GRANDE PROJECT-NEW MEXICO-Texas  
ELEPHANT BUTTE DISTRICT  
ANTHONY DRAIN  
RIGHT OF WAY  
FIELD WORK... J.R. .... CHECKED... G.W.H.  
DRAWN S.H.G.-A.M. APPROVED A.W.B.  
1242-1-102 EL PASO, TEX. 3/31

CONSTRUCTION DATES:  
365+26 to 367+80..... July 1920.  
367+80 to 397+85..... Mar. 1923.  
397+85 to 417+48..... Apr. 1923.

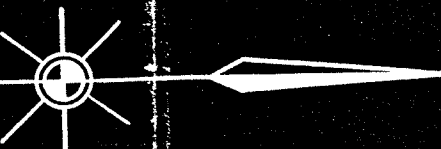

S. 0° 53' 39" W. 2644.4'  
TO S.W. COR. SEC. 4.

S. 89° 58' W.  
391 + 391.6'

N. 0° 02' W. 1108.6'

100'  
1/2 SEC. LINE.

30'  
70'

S. 0° 02' E. 2043.0'

NW 1/4 SW 1/4

W. COR. SEC. 4

9.2'

M. 0°

5.0° 0'

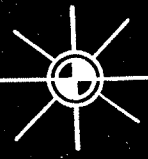

S 54°36' W. 55.17'  
S.W. Cor. Sec. 4

365 + 26.0

125.0

N. 89°57' W.

N. 0°07' W. 525.3'

50'

75'

S. 0°03' E. 234.0'

S. 5°03' E. 113.1'

S. 10°03' E. 28.4'

S. 4°50' E. 90.8'

S. 0°02' E. 106.6'

N. 66°02' E.  
107.63.5

N. 0°35'54" W. 4719.0' TO N.W. COR. SEC. 4

N. 0°07' W. 978.2'

113.3

107.6

107.6

107.6

107.6

107.6

107.6

107.6

107.6

107.6

107.6

107.6

107.6

107.6

107.6

S. 0°02'

1.5 ACRES  
LOT #1

PC37, TE#1

BDX. LINE REJECTED  
REFUGIO GRANT

1120100  
OFFICIAL DEED

THE FEDERAL LAND BANK OF WICHITA, a corporation

TO  
UNITED STATES OF AMERICA

STATE OF New Mexico )  
COUNTY OF Doña Ana ) SS.

This instrument was filed for record on  
the 27th day of August,  
19 40, at 4:25 o'clock P. M.,  
and was duly recorded in Book 886 at  
Page 43.

Wm. J. Conway Co. Bank  
By Wm. J. Conway

430.- 710

DEPARTMENT OF THE INTERIOR

Bureau of Reclamation

RIO GRANDE  
TRANSFER CASE

El Paso, Texas July 23, 1940

From Superintendent

To District Counsel

Subject: Acquisition of land utilized for drains - Deed under contract dated December 20, 1929, and contract of August 30, 1930, between the Elephant Butte Irrigation District and the United States - Rio Grande Project.

1. For your consideration, there is transmitted herewith, deed dated June 5, 1940, 19, from The Federal Land Bank of Wichita conveying 6.00 acres of land, in Sec. 4, Twp. 23 S, Range 3 E Dona Ana County, Plat No. 1565, Right of Way Plat No. 30, Anthony Drain, together with certificate of officials of the Elephant Butte Irrigation District dated July 15, 1940, 193, under the provisions of contract dated December 20, 1929, between said District and the United States.

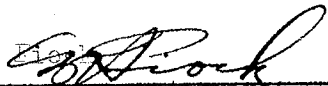
L.   
Superintendent

To Superintendent

El Paso, Texas, AUG 10 1940

The above described deed appears on its face to be in satisfactory form and to be properly executed. The certificate of the officials of the Elephant Butte Irrigation District as to title is properly executed and based thereon, in accordance with the provisions of the above mentioned contract, the deed and certificate are approved as to form and legal sufficiency and the deed may be recorded and the original thereof transmitted to the Washington office in the usual manner and credit may be extended to the District in the amount stated in said certificate in accordance with provisions of the above mentioned contract.

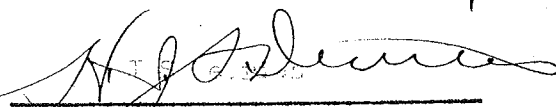
  
District Counsel

To The Commissioner

El Paso, Texas, OCT 29 1940

The deed above described has been accepted and recorded. The original executed deed and certificate are transmitted herewith to the Washington office for filing.

  
Superintendent

CC - Chief Engineer  
with enclosure



No. 1 of 4 Anthony 30

Serial 23-52A

File       

ELEPHANT BUTTE IRRIGATION DISTRICT

Las Cruces, New Mexico

July 15, 1940

CERTIFICATE TO ACCOMPANY QUIT CLAIM DEED

1. Reference is made to the accompanying quit claim deed from  
The Federal Land Bank of Wichita  
conveying 6.00 acres of land in Section 4, Township 26 South,  
Range 3 E, to The United States for drain right-of-way, and on  
account of which the District has fixed credit on assessments to be  
allowed the said grantor in the total sum of \$ 210.00,  
of which amount a credit of \$ --- has already  
been allowed by the District to the said landowner on assessments  
for the year --, pursuant to contract between the District  
and The United States dated December 20, 1929 and August 30, 1939

2. It is certified from investigation made, that the grantor(s)  
named in the said deed appear(s) to be the owner(s) and in possession  
of the land described in said deed and that said land was at the time  
of said conveyance free from tax liens and other recorded liens and  
encumbrances.

ELEPHANT BUTTE IRRIGATION DISTRICT

By Arthur Starr  
President

ATTEST:

D. A. Lowrey  
Secretary

(SEAL)